

Carver County Board of Commissioners
 Regular Session
 April 10, 2007
 County Board Room
 Carver County Government Center
 Human Services Building
 Chaska, Minnesota

PAGE

9:00 a.m.

- 1. a) **CONVENE**
- b) ***Pledge of Allegiance***
- c) ***Introduction of New Employees***
- 2. Agenda review and adoption
- 3. Approve minutes of April 3, 2007, Regular Session1-2
- 4. Public participation (Comments limited to five minutes)
- 5. Community announcements

9:05 a.m.

- 6. **CONSENT AGENDA**
- 6.1 Payment of emergency claims3-4
- 6.2 Award of bid for 2007 County funded overlay projects5-7
- 6.3 Award of bid for 2007 State aid funded overlay projects8-10
- 6.4 PSA with Minnesota Conservation Corps for reforestation
 planting.....11-12
- 6.5 Health Partners Letter of Agreement..... 13
- 6.6 Contract for installation of piezometers for curtain drain
 monitoring 14
- 6.7 Abatements/additions15-21
- 6.8 Demonstration project agreement-organics composting
 project grant with Minnesota Pollution Control Agency 22
- 6.9 Professional service agreement between Carver County Land and
 Water Division and Five Star Cinemas.....23
- 6.10 Family Homeless Prevention and Assistance Grant 24
- 6.11 Community Social Services' warrants..... NO ATT
- 6.12 Commissioners' warrants SEE ATT

9:05 am.

- 7. **SHERIFF**
- 7.1 National Public Safety Telecommunications Week
 April 8 – 14, 200725-26

9:10 a.m.

- 8. **LAND AND WATER SERVICES**
- 8.1 Wm. Mueller & Sons request to amend existing mining
 operation.....27-39

A Regular Session of the Carver County Board of Commissioners was held in the County Government Center, Chaska, on April 3, 2007. Chair Gayle Degler convened the session at 9:00 a.m.

Members present: Gayle Degler, Chair, James Ische, Vice Chair, Tim Lynch, Randy Maluchnik and Tom Workman.

Members absent: None.

Workman moved, Lynch seconded, to approve the agenda. Motion carried unanimously.

Maluchnik moved, Ische seconded, to approve the minutes of the March 27, 2007, Regular Session Motion carried unanimously.

Community announcements were made by the Board.

Ische moved, Lynch seconded, to approve the following consent agenda items:

Contract with Pinnacle Engineering not to exceed \$5,000.

Approved the contract for the sale of patrol dog "Koby" to Brian Dilley for \$1.00.

Accepted all quotations for Carver County Project No. 0703-metal culverts and corrugated polyethylene pipe.

Awarded Carver County Project No. 0704, mineral aggregates to Wm. Mueller & Sons, Inc., and Sibley Aggregates.

Awarded Carver County Project No. 0705, limestone rock, to Bryan Rock Products.

Awarded Carver County Project No. 0706, plant mixed asphalt, to Wm. Mueller & Sons, Inc., and Sibley Aggregates.

Awarded Carver County Project No. 0707, rock salt, to Cargill, Inc.

Awarded Carver County Project No. 0708, application of reflectorized pavement markings to Traffic Marking Service.

Accepted all quotations for Carver County Project No. 0709, rental equipment.

Resolution #30-07, Approving the Preliminary Plat of North Shore Farm.

Adopted the Findings of Fact and issue Order #PZ2007006 for the issuance of Conditional Use Permit #PZ2007006, J. Scott Miller, Watertown Township.

Adopted the Findings of Fact and issue Order #PZ20070008 for the issuance of Conditional Use Permit #PZ20070008, Mike Kugath, Benton Township.

Authorized increase of .17 FTE public health nurse position to a .50 FTE public health nurse, accepted funding from the Minnesota Department of Health in 2007 for TANF funding under the Local Public Health Act award and related Public Health budget amendment increasing grant revenue \$29,203 and increasing salaries and wages \$18,649 and professional services \$10,554.

Authorized Chair to sign agreements with McCombs, Frank Roos Associates, Inc., and The 106 Group and authorized staff to sign work orders under the contract.

Grant agreement between the Community Social Services Department and Carver Scott Educational Cooperative.

Approved increase in Financial Services petty cash fund from \$700 to \$1,200.

Community Social Services' actions.

Approved payment of the following Commissioners' warrants:

INSERT

Motion carried unanimously.

Ische moved, Degler seconded, to adjourn the Regular Session at 9:06 a.m. to go into a work session with Land and Water Services. Motion carried unanimously.

David Hemze
County Administrator

(These proceedings contain summaries of resolutions. The full text of the resolutions are available for public inspection in the office of the county administrator.)



Office of Finance Director
Carver County Government Center
Administration Building
600 East Fourth Street
Chaska, MN 55318-1202
Phone: 952 361-1509
Fax: 952 361-1308

AUTHORIZATION

PAYMENT OF EMERGENCY CLAIM

Motion passed by the Board of County Commissioners at their February 24, 1987 meeting has authorized the issuance of a check upon the consensus of the Chairman of the Board, County Administrator and the County Attorney (with minimum of two).

VENDOR: Hazeltine Shores

ACCOUNT: 11-429-710-3040-0041

AMOUNT: \$900

REASON: Rent for a client in the CS family
Alternative response program - secure
Department Head Signature: Wendy Bonebrake Housing

Chairman of County Board

James Ische

County Administrator

Dave Hemze
Dave Hemze

County Attorney

Michael A. Fahey
Michael A. Fahey

Date: 4-2-87



Office of Finance Director
Carver County Government Center
Administration Building
600 East Fourth Street
Chaska, MN 55318-1202
Phone: 952 361-1509
Fax: 952 361-1308

AUTHORIZATION

PAYMENT OF EMERGENCY CLAIM

Motion passed by the Board of County Commissioners at their February 24, 1987 meeting has authorized the issuance of a check upon the consensus of the Chairman of the Board, County Administrator and the County Attorney (with a minimum of two).

VENDOR: Carver County

ACCOUNT: _____

AMOUNT: ~~\$128.00~~ 61.00

REASON: Certified birth certificates for grand jury

Department Head Signature: Michael A. Fahey

Chairman of County Board

James Ische

County Administrator

David Hemze

County Attorney

Michael A. Fahey

Date: 3/29/07



REQUEST FOR BOARD ACTION

AGENDA ITEM : AWARD OF BID FOR 2007 COUNTY FUNDED OVERLAY PROJECTS

Originating Division: Public Works

Meeting Date: April 10, 2007

Amount of Time Requested: n/a

Attachments for packet: Yes No

Item Type: Consent Regular Session Closed Session Work Session Ditch/Rail Authority

BACKGROUND/EXPLANATION OF AGENDA ITEM: Bids have been received for the 2007 County Funded Bituminous Overlay Projects. The low bidder on the project is Wm. Mueller & Sons, Hamburg. The bid amount is \$308,652.70. A location map and abstract of bids are attached. Project locations are chosen annually based on pavement condition.

ACTION REQUESTED: It is recommended that the County Board award the bid to Wm. Mueller & Sons in the amount of \$308,652.70.

FUNDING

County Dollars = \$308,700.00

Other Sources & Amounts =

= \$

TOTAL

= \$308,700.00

FISCAL IMPACT

None

Included in current budget

Budget amendment requested

Other:

Related Financial Comments:

Reviewed by Division Director

Date:

4/4/07

S:\Projects\Overlays\2007\BAF - Award Bid - CR

CARVER COUNTY - ABSTRACT 2007 OVERLAY PROJECT (COUNTY ROAD)

BID OPENING: TUESDAY, APRIL 3, 2007 - 10:00 AM

Project No.	Item No.	Item Description	Unit	Quantity	Engineer's Estimate		Wm. Mueller & Sons, Inc. Hamburg, MN		Chart Tiling & Exc. Belle Plaine, MN		Knife River Corp. Sauk Rapids, MN		Valley Paving Shakopee, MN		Handwies, Inc. Rogers, MN	
					Unit Price	Amount	Unit Price	Amount	Unit Price	Amount	Unit Price	Amount	Unit Price	Amount	Unit Price	Amount
(8470) CP 07-152	2221.501	Aggregate Shouldering, CL. 2	Ton	820	15.30	12,546.00	15.00	12,300.00	18.00	14,760.00	16.77	13,751.40	19.05	15,621.00	25.00	20,500.00
	2232.501	Mill Bituminous Surface 3"	S.Y.	38,622	1.00	38,622.00	0.60	23,173.20	0.50	19,311.00	1.24	47,891.28	0.79	30,511.38	0.95	36,690.90
	2350.501	Type LV4 Wearing Course Mixture (B)	Ton	3,500	38.00	133,000.00	34.50	120,750.00	37.60	131,600.00	44.13	154,455.00	43.78	153,230.00	49.85	174,475.00
	2350.502	Type LV3 Non-Wear Course Mixture (B)	Ton	3,500	38.00	133,000.00	31.50	110,250.00	33.15	116,025.00	31.44	110,040.00	40.99	143,465.00	48.40	169,400.00
	2357.502	Bituminous Material for Tack Coat	Gal	3,245	1.15	3,731.75	1.50	4,867.50	1.50	4,867.50	1.55	5,029.75	1.64	5,321.80	1.70	5,516.50
	2540.602	Mailbox Support	Each	12	110.00	1,320.00	100.00	1,200.00	100.00	1,200.00	104.30	1,251.60	112.78	1,353.36	200.00	2,400.00
2580.501	Temporary Lane Marking	L.F.	2,528	0.50	1,264.00	1.50	3,792.00	0.50	1,264.00	0.32	808.96	0.55	1,390.40	1.25	3,160.00	
TOTAL - CP 07-152						\$323,483.75		\$276,332.70		\$289,027.50		\$333,227.99		\$350,892.94		\$412,142.40
(8471)	2350.501	Type LV4 Wear Course Mixture (B)	Ton	480	50.00	24,000.00	65.00	31,200.00	57.00	27,360.00	76.36	36,652.80	52.03	24,974.40	64.00	30,720.00
CP 0710	2357.502	Bituminous Material for Tack Coat	Gal	240	1.50	360.00	600.00	2.50	480.00	2.00	480.00	1.59	381.60	3.50	840.00	
Sheet Patching	2580.501	Temporary Lane Marking	L.F.	260	1.00	260.00	520.00	2.00	520.00	0.50	130.00	0.32	83.20	1.64	426.40	
TOTAL - CP 0710 (Sheet Patching)						\$24,620.00		\$32,320.00		\$27,970.00		\$37,117.60		\$26,240.80		\$32,580.00
GRAND TOTAL - ALL PROJECTS						\$348,103.75		\$308,652.70		\$316,997.50		\$370,345.59		\$377,133.74		\$444,722.40

CARVER COUNTY

2007 Overlays

Location Map

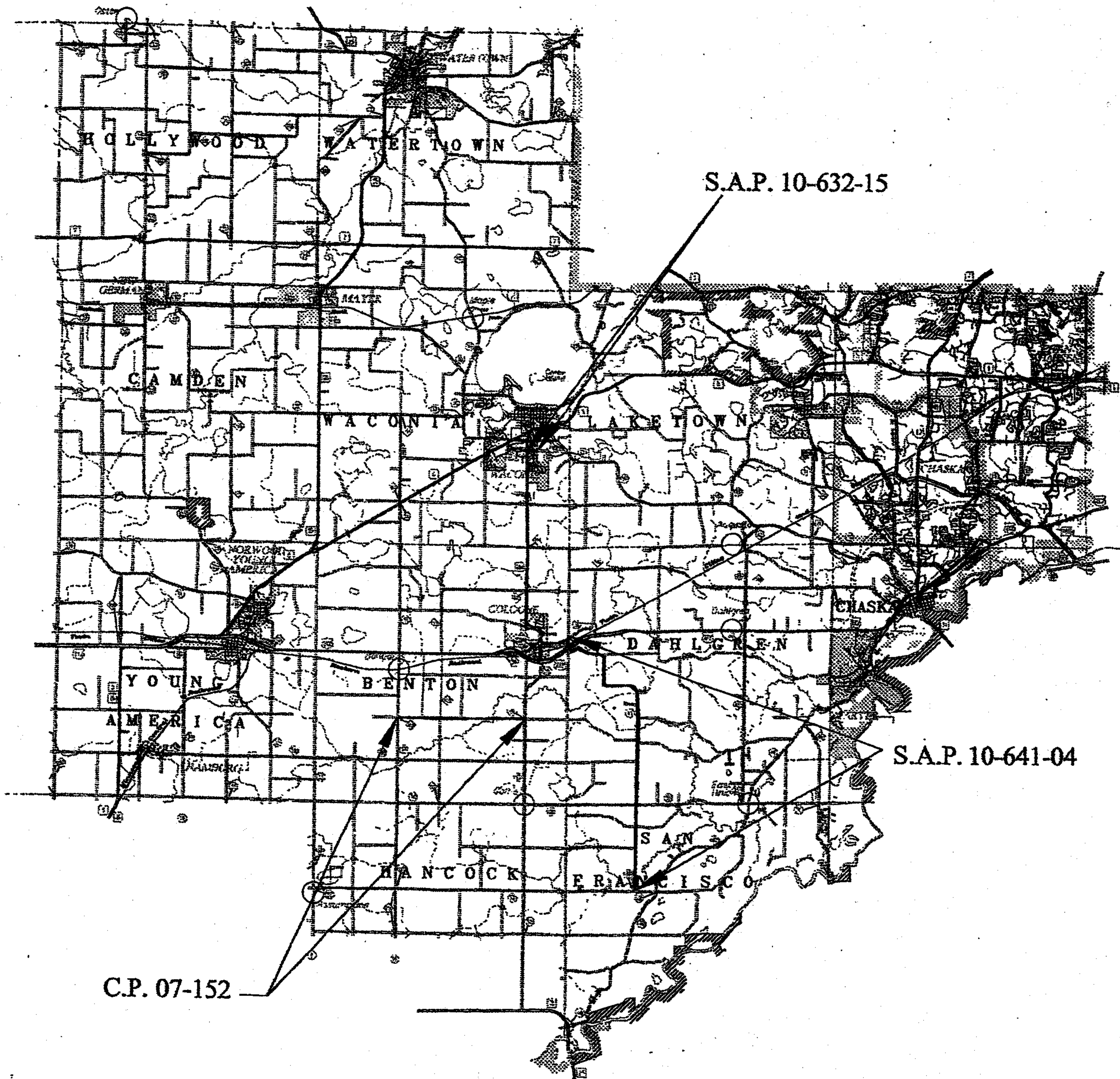

"COMPLETED UNDER SEPARATE CONTRACT" UNDER SAP 10-632-15 & SAP 10-641-04



REQUEST FOR BOARD ACTION

AGENDA ITEM : AWARD OF BID FOR 2007 STATE-AID FUNDED OVERLAY PROJECTS

Originating Division: Public Works

Meeting Date: April 10, 2007

Amount of Time Requested: n/a

Attachments for packet: Yes No

Item Type: Consent Regular Session Closed Session Work Session Ditch/Rail Authority

BACKGROUND/EXPLANATION OF AGENDA ITEM: Bids have been received for the 2007 State-Aid Funded Bituminous Overlay Projects. The low bidder on the project is Wm. Mueller & Sons, Hamburg. The bid amount is \$785,289.00. A location map and abstract of bids are attached. Project locations are chosen annually based on pavement condition.

ACTION REQUESTED: It is recommended that the County Board award the bid to Wm. Mueller & Sons in the amount of \$785,289.00.

FUNDING

County Dollars =	\$720,000.00
Other Sources & Amounts =	
State Aid	=\$66,000.00
TOTAL	= \$786,000.00

FISCAL IMPACT

None
 Included in current budget
 Budget amendment requested
 Other:

Related Financial Comments:

Reviewed by Division Director

Date: 4/4/07

S:\Projects\Overlays\2007\BAF - Award Bid - CSAH

CARVER COUNTY - ABSTRACT 2007 OVERLAY PROJECT (CSAH)

BID OPENING: TUESDAY, APRIL 3, 2007 - 10:00 AM

Project No.	Item No.	Item Description	Unit	Quantity	Engineer's Estimate		Wm. Mueller & Sons, Inc. Hamburg, MN		Gard Tilling & Exc. Belle Plaine, MN		Knife River Corp. Sauk Rapids, MN		Valley Paving Shakopee, MN		Hardrives, Inc. Rogers, MN	
					Unit Price	Amount	Unit Price	Amount	Unit Price	Amount	Unit Price	Amount	Unit Price	Amount	Unit Price	Amount
(8468) S.A.P. 10-632-15	2232.501	Mill Bituminous Surface 3"	S.Y.	6,481	1.00	6,481.00	1.25	8,101.25	0.50	3,240.50	2.29	14,841.49	0.96	6,221.76	1.80	11,665.80
	2350.501	Type MV4 Wearing Course Mixture (F)	Ton	560	65.00	36,400.00	50.50	28,280.00	50.40	28,224.00	65.58	36,724.80	58.25	32,620.00	65.00	36,400.00
	2350.502	Type MV3 Non-Wear Course Mixture (F)	Ton	560	55.00	30,800.00	50.50	28,280.00	45.40	25,424.00	55.74	31,214.40	53.90	30,184.00	59.50	33,320.00
	2357.502	Bituminous Material for Tack Coat	Gal	545	1.25	681.25	1.75	953.75	1.50	817.50	1.57	855.65	2.50	1,362.50	1.70	926.50
	2580.501	Temporary Lane Marking	L.F.	104	0.50	52.00	1.50	156.00	0.50	52.00	1.99	206.96	1.63	169.52	3.50	364.00
TOTAL - S.A.P. 10-632-15						\$74,414.25		\$65,771.00		\$57,758.00		\$83,843.30		\$70,557.78		\$82,676.30
(8469) S.A.P. 10-641-04	2221.501	Aggregate Shouldering, CL. 2	Ton	5,590	15.30	85,527.00	14.00	78,260.00	17.00	95,030.00	22.05	123,259.50	16.90	94,471.00	23.50	131,365.00
	2350.501	Type LV4 Wearing Course Mixture (B)	Ton	9,265	42.00	389,130.00	35.00	324,275.00	38.75	359,018.75	45.18	418,592.70	43.56	403,583.40	47.75	442,403.75
	2350.502	Type LV3 Non-Wear Course Mixture (B)	Ton	9,265	42.00	389,130.00	31.50	291,847.50	34.35	318,252.75	34.82	322,607.30	40.73	377,363.45	45.50	421,557.50
	2357.502	Bituminous Material for Tack Coat	Gal	8,610	1.15	9,901.50	1.65	14,206.50	1.50	12,915.00	1.55	13,345.50	1.74	14,981.40	1.70	14,637.00
	2540.602	Mailbox Support	Each	18	110.00	1,980.00	100.00	1,800.00	100.00	1,800.00	106.12	1,910.16	112.49	2,024.82	165.00	2,970.00
2580.501	Temporary Lane Marking	L.F.	6,086	0.50	3,043.00	1.50	9,129.00	0.50	3,043.00	0.18	1,095.48	0.54	3,286.44	0.50	3,043.00	
TOTAL - S.A.P. 10-641-04						\$878,711.50		\$719,518.00		\$790,059.50		\$880,810.64		\$895,710.51		\$1,015,976.25
GRAND TOTAL - ALL PROJECTS						\$953,125.75		\$785,289.00		\$847,817.50		\$964,653.94		\$966,268.29		\$1,098,652.55

CARVER COUNTY

2007 Overlays

Location Map

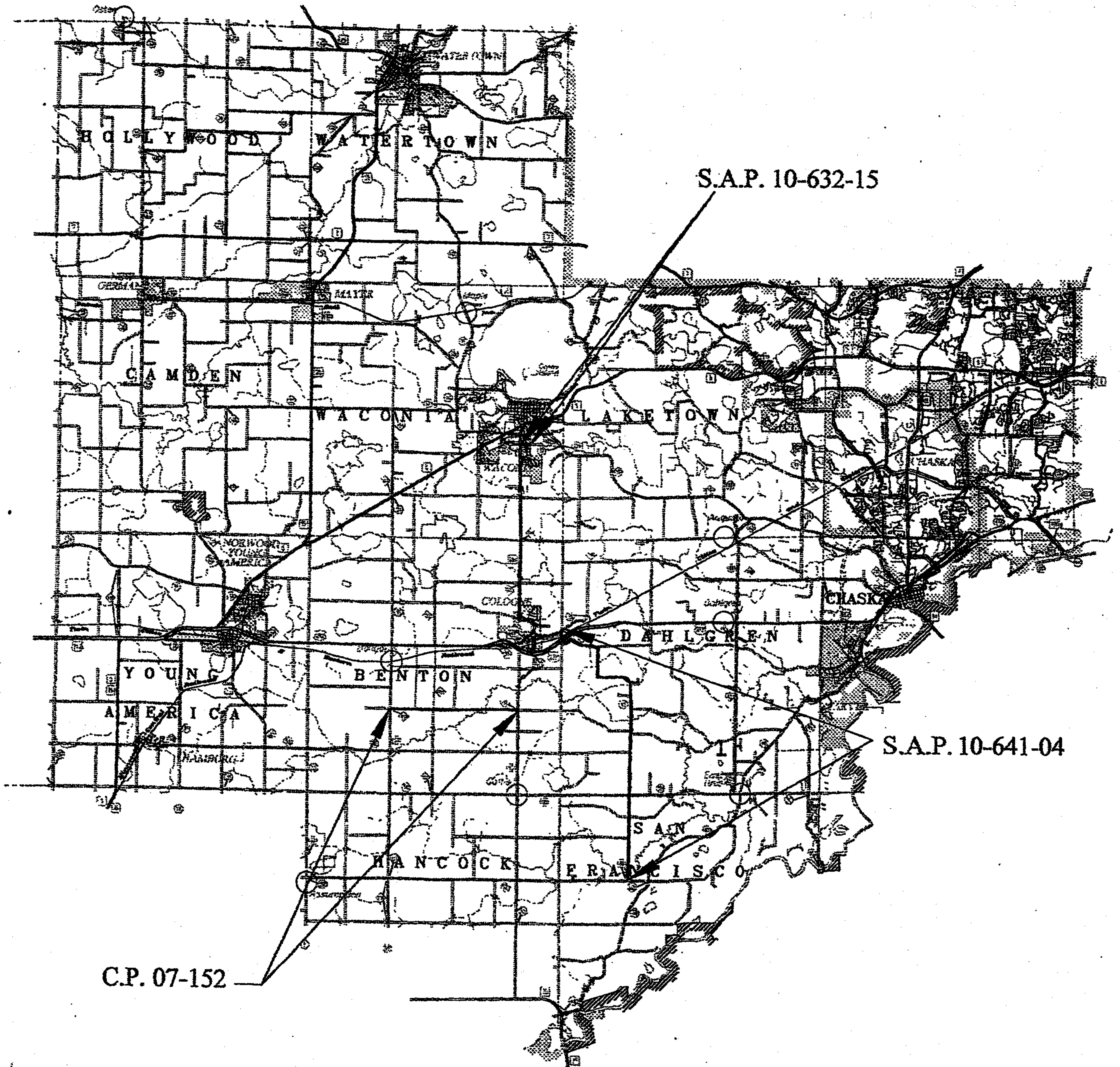

"COMPLETED UNDER SEPARATE CONTRACT" UNDER CP 07-152



REQUEST FOR BOARD ACTION

AGENDA ITEM : PSA with Minnesota Conservation Corps for reforestation planting

Originating Division: Public Works - Parks

Meeting Date: 4/3/2007

Amount of Time Requested: 0

Attachments for packet: Yes No

Item Type: Consent Regular Session Closed Session Work Session Ditch/Rail Authority

BACKGROUND/EXPLANATION OF AGENDA ITEM:

The Carver County Parks Department received a restoration grant through the Metro Greenways program administered by the MN DNR to conduct a 12 acres reforestation project at Lake Minnewashta Regional Park. The agreement with the Friends Of The Minnesota Conservation Corps (MCC) is to assist with the planting of the 16,500 trees and shrubs in April of 2007. The work for this grant must be completed no later than June 30th, 2007. The ideal time to plant tree and shrub seedlings is mid April to the first part of May. In order to get all the seedlings planted in a timely manner it is necessary to bring in a work crew with experience in reforestation projects such as this one which the MCC has.

ACTION REQUESTED: It is recommended that the County Board authorize the County Board Chair and the County Administrator to sign the Professional Service Agreement and the MCC Service Agreement.

FUNDING

County Dollars =	\$
Other Sources & Amounts =	5,250.00
	= \$
TOTAL	= \$5,250.00

FISCAL IMPACT

None
 Included in current budget
 Budget amendment requested
 Other:

Related Financial Comments: Funds are budgeted and expenses will be reimbursed through the Metro Greenways Grant program at administered by MN DNR.

Reviewed by Division Director

Date:

3/13/07

S:\Parks\BA and RES\RBA - MCC work crew PSA.doc

**BOARD OF COUNTY COMMISSIONERS
CARVER COUNTY, MINNESOTA**

Date: 4/03/07

Resolution No: _____

Motion by Commissioner: _____

Seconded by Commissioner: _____

PROFESSIONAL SERVICE AGREEMENT
BETWEEN
THE FRIENDS OF THE MINNESOTA CONSERVATION CORPS AND CARVER
COUNTY
FOR PLANTING OF TREES AND SHRUBS AS PART OF THE REFORESTATION
PROJECT AT LAKE MINNEWASHTA REGIONAL PARK

BE IT RESOLVED, that the Carver County Board of Commissioners hereby authorize the Board Chair and the County Administrator to execute the Professional Service Agreement between the Friends Of The Minnesota Conservation Corps and Carver County for the planting of 16,500 trees and shrubs at Lake Minnewashta Regional Park.

YES

ABSENT

NO

STATE OF MINNESOTA
COUNTY OF CARVER

I, David Hemze, duly appointed and qualified County Administrator of the County of Carver, State of Minnesota, do hereby certify that I have compared the foregoing copy of this resolution with the original minutes of the proceedings of the Board of County Commissioners, Carver County, Minnesota, at its session held on the 3 day of April, 2007, now on file in the Administration office, and have found the same to be a true and correct copy thereof.

Dated this 3 day of April, 2007.

County Administrator



REQUEST FOR BOARD ACTION

AGENDA ITEM : Health Partners Letter of Agreement

Originating Division: Employee Relations

Meeting Date: 4/10/07

Amount of Time Requested: Consent

Attachments for packet: Yes NoItem Type: Consent Regular Session Closed Session Work Session Ditch/Rail Authority**BACKGROUND/EXPLANATION OF AGENDA ITEM:**

Health Partners has requested that we sign the attached letter of agreement that outlines the rates and rate guarantee for the second year. Health Partners has indicated that since we have gone back to a fully funded, fully insured plan there is no need to sign a contract - just the letter of agreement. Contract attached for reference.

ACTION REQUESTED:

Motion to approve the Health Partners Letter of Agreement.

FUNDING**FISCAL IMPACT**

County Dollars = \$5,297,000
 Other Sources & Amounts =
 = \$
TOTAL = \$5,297,000

None
 Included in current budget
 Budget amendment requested
 Other:

Related Financial Comments:

Amount indicated above was previously approved through a 9/12/06 Board Action addressing 2007 rates.

 Reviewed by Division Director

Date: 4/2/07



REQUEST FOR BOARD ACTION

AGENDA ITEM : Contract for Installation of Piezometers for Curtain Drain Monitoring

Originating Division: Land Water Services

Meeting Date: 4/10/2007

Amount of Time Requested: 0

Attachments for packet: Yes No

Item Type: Consent Regular Session Closed Session Work Session Ditch/Rail Authority

BACKGROUND/EXPLANATION OF AGENDA ITEM:

Some individual Sewage Treatment Systems require soil borings and installation of monitoring devices [piezometers] to determine whether or not they are in compliance with state and County guidelines. Typically these are "curtain drain" type systems that depend on a tile line to lower a seasonally high groundwater table. The County collects fees from homeowners to complete the soil borings and install piezometers. This contract provides for the installation of the piezometers by a licensed private contractor. Environmental Services staff does the actual monitoring of water levels after the piezometers are installed. Letters requesting quotes for installation were sent to eight licensed contractors. Two quotes were submitted; one from HomeStead Septic at a price of \$290.00 per site for 2007 and \$300.00 per site in 2008; one from Swedlund Septic Services Inc. for a price of \$300.00 per site for 2007 and 2008.

It is expected that approximately eight systems will need to have piezometers installed in both 2007 & 2008. The net difference between the two proposals is \$80 maximum (based on 8 systems in 2007), with Swedlund being the more expensive. Based on past performance by both firms the staff is requesting that the contract be awarded to Swedlund Services Inc.

ACTION REQUESTED: Motion awarding the contract to Swedlund Septic Services Inc. and authorize the Chair's signature on all necessary documents.

FUNDING

County Dollars =	\$2,000
Other Sources & Amounts =	
Fees =	\$4000
TOTAL	= \$6,000

FISCAL IMPACT

None
 Included in current budget
 Budget amendment requested
 Other:

Related Financial Comments: There are up to eight systems that may need to be completed in 2007 and eight additional in 2008. The contract has not to exceed figure of \$6,000; this amount provides for up to 4 additional systems above the expected number of systems.

Reviewed by Division Director

Date: 29 March 2007



REQUEST FOR BOARD ACTION

AGENDA ITEM : Abatements/Additions

Originating Division: Property Records Taxpayer Services

Meeting Date: 04/10/07

Amount of Time Requested: 0 minutes

Attachments for packet: Yes No

Item Type: Consent Regular Session Closed Session Work Session Ditch/Rail Authority

BACKGROUND/EXPLANATION OF AGENDA ITEM: See Attached.

ACTION REQUESTED:

FUNDING

County Dollars =	\$-3,447.77
Other Sources & Amounts =	-7,012.23
	=
TOTAL	= \$-10,460.00

FISCAL IMPACT

- None
- Included in current budget
- Budget amendment requested
- Other: Not Budgeted

Related Financial Comments:

Reviewed by Taxpayer Services Manager

Laura Grogan

Date: 4-2-07



Office of County Assessor
Angela Johnson
Carver County Government Center
Administration Building
600 East Fourth Street
Chaska, Minnesota 55318-2102
Phone: (952) 361-1960
Fax: (952) 361-1959

**Abatements presented to the
Carver County Board of Commissioners**

The following properties are to be classified as Tax Exempt for taxes assessed in 2002 and payable in 2003, and also for the taxes assessed in 2003 and payable in 2004, these parcels are owned by homeowners association. These are recommended for approval by the County Assessor.

30-105-0690	Clover Field Community Assoc.	Residential
30-105-0700	Clover Field Community Assoc.	Residential
30-105-0710	Clover Field Community Assoc.	Residential
30-107-0080	Clover Field Community Assoc.	Residential

The following property is to be classified as Tax Exempt for taxes assessed in 2002 and payable in 2003, 2003 assessed and payable in 2004, 2004 assessed payable in 2005, 2005 assessed and payable in 2006, and 2006 assessed payable in 2007, the property is owned by a twin home association. This is recommended for approval by the County Assessor.

75-270-0610	Fronterra Twin Homes Assoc.	Residential
-------------	-----------------------------	-------------

The following property is to be classified as Tax Exempt for taxes assessed in 2004 and payable 2005 and assessed in 2005 payable 2006, this property was taken for roads through condemnation. This is recommended for approval by the County Assessor.

75-018-0100	Stan & Marie Radde Trust	Agricultural
-------------	--------------------------	--------------

The following properties had a portion taken through condemnation for roads; this is for the 2004 assessment payable 2005, 2005 assessment payable 2006, and 2006 assessment payable 2007 a reduction of value is warranted for these years. This is recommended for approval by the County Assessor.

07-019-1300	Paradise Partners LLP	Agricultural
09-024-0400	Mike Hartmann	Agricultural

The following properties are to be classified as Tax Exempt for taxes assessed in 2004 and payable 2005, 2005 assessed and payable 2006, and 2006 assessed payable 2007, these properties were taken for roads through condemnation. These are recommended for approval by the County Assessor.

07-018-1300	Patrick Kirsch	Agricultural
-------------	----------------	--------------

The following property is to be classified as Tax Exempt for taxes assessed in 2004 payable 2005, and 2005 payable 2006, these properties were taken for roads through condemnation. These are recommended for approval by the County Assessor.

07-018-1400	Gary Heinze	Agricultural
-------------	-------------	--------------

The following properties are to be classified as Tax Exempt for the 2006 assessment payable 2007, as they are owned by Tax Exempt entities; these are recommended for approval by the County Assessor.

06-026-0200	State of Minnesota.	Residential
07-018-1400	Carver County	Agricultural
25-027-0500	State of Minnesota	Residential

The following property is warranted abatement for the 2006 assessment payable 2007, due to a split. This is recommended for approval by the County Assessor.

06-013-0810	Cory Fiecke	Agricultural
-------------	-------------	--------------

Page 3

The following is an added tax for a parcel that was created from a split that was missed; this is for the 2006 assessment payable 2007. This is recommended for approval by the County Assessor.

10-018-0930	Cory Fiecke	Agricultural
-------------	-------------	--------------

The following property is warranted abatement for the 2006 assessment payable 2007, due to a split. This is recommended for approval by the County Assessor.

06-013-0800	Brent Muchow	Residential
-------------	--------------	-------------

The following is an added tax for a parcel that was created from a split that was missed; this is for the 2006 assessment payable 2007. This is recommended for approval by the County Assessor.

10-018-0940	Brent Muchow	Residential
-------------	--------------	-------------

The following property is warranted a change in the classification due to the primary use of the property; this is for the 2006 assessment payable 2007. This is recommended for approval by the County Assessor.

25-035-1800	Skip Cook	Commercial
-------------	-----------	------------

The following properties are to receive the homestead credit for the 2006 assessment payable 2007. They are recommended for approval by the County Assessor.

04-017-0610	Corey Olson	Residential
-------------	-------------	-------------

06-034-0611	Gregory Bury	Residential
-------------	--------------	-------------

09-005-1000	Jeffrey Kron	Residential
-------------	--------------	-------------

09-020-0210	Donald Goblsh	Residential
-------------	---------------	-------------

25-063-1130	Eric McClellan	Residential
25-406-0060	Brent Sinn	Residential
25-757-0030	Thomas Houck	Residential
25-757-0400	Alex Tsegai	Residential
30-100-0090	Thomas Therres	Residential
30-176-0040	Stephen Barnes	Residential
30-492-0904	Thomas Merriam	Residential
40-800-0210	Lydene Vinkemeier	Residential
58-012-0250	James Bortz	Residential
75-065-0090	Jennifer Johnson	Residential

The following property is to receive the homestead credit for the following years 2004 assessment payable 2005, 2005 assessment payable 2006, and 2006 assessment payable 2007, the owners failed to apply for the homestead credit. These are recommended for approval by the County Assessor.

58-011-2210	Thomas Anderson	Residential
-------------	-----------------	-------------

The following property is to receive the homestead credit for 2004 assessment payable 2005, 2005 assessment payable 2006, and 2006 assessment payable 2007, as the homestead was removed in error.

30-050-4940	Donna Wensch	Residential
-------------	--------------	-------------

The following property is to receive the homestead credit for the 2005 assessment payable 2006, the owners failed to apply for the homestead credit. This is recommended for approval by the County Assessor.

04-017-0610	Corey Olson	Residential
-------------	-------------	-------------



**CARVER
COUNTY**

Taxpayer Services Department
Government Center - Administration Building
600 East 4th Street
Chaska, MN 55318-2102
Phone (952) 361-1910
Fax (952) 361-1919
www.co.carver.mn.us

Laurie Engelen
Taxpayer Services Manager
Phone: (952) 361-1907
Email: lengelen@co.carver.mn.us

**Abatements presented to the
Carver County Board of Commissioners
April 10, 2007**

Payable Year	Parcel Number	Name	Original Tax Amount	Adjusted Tax Amount	County Dollars Abated	Total Amount of Adjustment
2003	75-2700610	Fronterra Twin Homes Homeowners Assn	2.00	0.00	-1.22	-2.00
2004	75-2700610	Fronterra Twin Homes Homeowners Assn	2.00	0.00	-1.28	-2.00
2005	75-2700610	Fronterra Twin Homes Homeowners Assn	2.00	0.00	-1.27	-2.00
2006	75-2700610	Fronterra Twin Homes Homeowners Assn	2.00	0.00	-1.23	-2.00
2007	75-2700610	Fronterra Twin Homes Homeowners Assn	2.00	0.00	-1.19	-2.00
2003	30-1050690	Clover Field Community Assn	2.00	0.00	-1.22	-2.00
2004	30-1050690	Clover Field Community Assn	2.00	0.00	-1.19	-2.00
2003	30-1050700	Clover Field Community Assn	2.00	0.00	-1.22	-2.00
2004	30-1050700	Clover Field Community Assn	2.00	0.00	-1.19	-2.00
2003	30-1050710	Clover Field Community Assn	2.00	0.00	-1.22	-2.00
2004	30-1050710	Clover Field Community Assn	2.00	0.00	-1.19	-2.00
2003	30-1070080	Clover Field Community Assn	2.00	0.00	-1.22	-2.00
2004	30-1070080	Clover Field LLC	2.00	0.00	-1.19	-2.00
2007	09-0051000	Jeffrey Kron	2,800.00	2,712.00	-40.54	-88.00
2007	30-4920904	Thomas Merriam	2,110.00	1,896.00	-82.13	-214.00
2007	58-0112210	Thomas & Jenny Anderson	2,386.00	2,202.00	-69.20	-184.00
2007	25-7570030	Thomas Houck	1,496.00	1,230.00	-97.03	-266.00
2007	25-7570400	Alex Tsegai	1,524.00	1,258.00	-98.23	-266.00
2007	07-0181300	Patrick & Anthony Kirsch	66.00	0.00	-28.78	-66.00
2006	07-0181300	Patrick & Anthony Kirsch	56.00	0.00	-26.18	-56.00
2005	07-0181300	Patrick & Anthony Kirsch	46.00	0.00	-23.49	-46.00
2007	07-0181400	Carver County	102.00	0.00	-44.44	-102.00
2006	07-0181400	Gary & Orla Heinze	86.00	0.00	-39.83	-86.00
2005	07-0181400	Gary & Orla Heinze	66.00	0.00	-33.91	-66.00
2007	07-0191300	Paradise PI LLC Etal	9,532.00	8,528.00	-434.80	-1,004.00
2006	07-0191300	Paradise Partners LLP	4,396.00	4,052.00	-158.82	-344.00
2005	07-0191300	Paradise Partners LLP	3,214.00	3,066.00	-75.48	-148.00
2006	75-0180100	Stan & Marie Radde Trust	3,914.00	2,586.00	-608.95	-1,328.00
2005	75-0180100	Stan & Marie Radde Trust	30.00	14.00	-8.50	-16.00
2007	06-0130800	Brent & Krista Muchow	2,186.00	2,176.00	-4.16	-10.00
2007	10-0180940	Brent & Krista Muchow	0.00	4.00	1.13	4.00

Payable Year	Parcel Number	Name	Original Tax Amount	Adjusted Tax Amount	County Dollars Abated	Total Amount of Adjustment
2007	25-0270500	State of MN - DOT	14.00	0.00	-4.75	-14.00
2007	06-0260200	State of MN - DOT	50.00	0.00	-21.38	-50.00
2007	25-0351800	Skipper S Cook	4,850.00	2,282.00	-54.67	-2,568.00
2005	09-0240400	Michael & Patricia Hartmann	2,682.00	2,590.00	-49.25	-92.00
2006	09-0240400	Michael & Patricia Hartmann	3,054.00	2,870.00	-89.89	-184.00
2007	09-0240400	Michael & Patricia Hartmann	3,452.00	3,112.00	-156.48	-340.00
2007	06-0340611	Gregory & Brenda Bury	2,360.00	2,218.00	-63.54	-142.00
2007	09-0200210	Donald G Goblish Jr	2,300.00	2,146.00	-70.55	-154.00
2007	04-0170610	Corey Olson	2,634.00	2,514.00	-55.71	-120.00
2006	04-0170610	Corey Olson	2,308.00	2,154.00	-76.52	-154.00
2007	75-0650090	Jennifer Johnson	2,486.00	2,302.00	-65.76	-184.00
2007	25-4060060	Brent Sinn	3,252.00	3,110.00	-52.02	-142.00
2007	25-0631130	Eric McClellan & Sharon Anderson	1,916.00	1,678.00	-87.89	-238.00
2007	30-1760040	Stephen & Julie Barnes	4,610.00	4,584.00	-11.00	-26.00
2007	30-1000090	Thomas Therres	2,064.00	1,846.00	-84.01	-218.00
2007	40-8000210	Lloyd & Lydene Vinkemeier	2,592.00	2,436.00	-60.68	-156.00
2007	30-0504940	Donna Wenisch	1,332.00	1,060.00	-103.75	-272.00
2007	58-0120250	James Bortz	3,374.00	3,270.00	-39.14	-104.00
2005	30-0504940	Donna Wenisch	1,004.00	706.00	-128.64	-298.00
2006	30-0504940	Donna Wenisch	1,114.00	828.00	-118.04	-286.00
			\$86,016.00	\$75,556.00	-\$3,447.77	-\$10,460.00



REQUEST FOR BOARD ACTION

AGENDA ITEM : Demonstration Project Agreement – Organics Composting Project Grant with MN Pollution Control Agency.

Originating Division: Land and Water

Meeting Date: April 10, 2007

Amount of Time Requested: NA

Attachments for packet: No

Item Type: X Consent Regular Session Closed Session Work Session Ditch/Rail Authority

BACKGROUND/EXPLANATION OF AGENDA ITEM:

Environmental Services received a \$55,000 grant from the Minnesota Pollution Control Agency (MPCA) to conduct a Demonstration/Research Project to investigate the environmental impacts of composting source separated organics from residents with yard waste. The actual grant contract and budget was approved by the County Board in June of 2006. This agreement identifies project details and actions to be taken by the MPCA, the compost site operator [RW Farms] and Carver County. It is in addition to the Grant contract and budget.

ACTION REQUESTED: Motion to approve Demonstration Project Agreement with the Minnesota Pollution Control Agency.

FUNDING

County Dollars =	\$7,620
Other Sources & Amounts =	
	= \$55,000
TOTAL	= \$62,620

FISCAL IMPACT

None
 Included in current budget X
 Budget amendment requested
 Other:

Related Financial Comments: The matching funds provided by the County are budgeted as part of the 2007 solid waste budget. The grant agreement and budget were approved by the County Board in June 2006.

Reviewed by Division Director

Date:

2 Apr 07



REQUEST FOR BOARD ACTION

AGENDA ITEM : Professional Service Agreement between carver County Land Water Division and five Star Cinemas

Originating Division: Land and Water

Meeting Date: April 10, 2007

Amount of Time Requested: NA

Attachments for packet: No

Item Type: X Consent Regular Session Closed Session Work Session Ditch/Rail Authority

BACKGROUND/EXPLANATION OF AGENDA ITEM:

Participation at the Environmental Center has plateau at approximately 16,000 visits over the last few years. Environmental Services has been discussing means of promoting the E.C. to county residents. The 2007 goal for the Environmental Center is to raise the level of participation to 18,000. One approach we recommend is the advertise in the theaters in Chaska and Chanhassen. The theater in Waconia was also contacted but they were unable to add new advertisement at this time. Staff will contact them in the future to discuss advertisement options.

Five Star Cinemas will produce a 15 second add that will combined an audio commentary with clips of the facility. Since most of the calls coming into the Department and E.C. are related to time of operation, location, and what material are accepted, the adds will focus on these issues.

ACTION REQUESTED: Motion to approve the Service Agreement with Five Star Cinemas to provide advertising services for the Environmental Center.

FUNDING

County Dollars =	\$6,000
Other Sources & Amounts =	\$
	= \$
TOTAL	= \$6,000

FISCAL IMPACT

None
 Included in current budget X
 Budget amendment requested
 Other:

Related Financial Comments: The County will recouped an approximately \$1,000 from a Community Powers grant from the Solid Waste Management Coordinating Board.

Reviewed by Division Director

Date:

2 Apr 07



REQUEST FOR BOARD ACTION

AGENDA ITEM : Family Homeless Prevention and Assistance Grant (FHPAP)

Originating Division: Community Social Services

Meeting Date: 4/10/07

Amount of Time Requested: NA

Attachments for packet: Yes No

Item Type: Consent Regular Session Closed Session Work Session Ditch/Rail Authority

BACKGROUND/EXPLANATION OF AGENDA ITEM: Community Social Services is seeking Carver County Board Approval to apply for the Family Homeless Prevention and Assistance Program (FHPAP) Grant. This grant would not require any Carver County tax dollars be involved.

If approved through Minnesota Housing and Finance Agency, this program will assist singles and families who are homeless or at imminent risk of homelessness. The FHPAP will encourage and support innovation through multiple agencies to create a community wide response system to focus on prevention.

The target populations will be families, unaccompanied youth, single adults with an emphasis on veterans.

The goal of the program will be to stabilize families in existing homes, to minimize the length of homelessness and to eliminate repeat episodes of homelessness. The services and assistance provided will include case management and direct support for such things as rental assistance, utility assistance, and security deposits just to name a few assistance areas.

ACTION REQUESTED: Motion authorizing the submittal of the Family Homeless Prevention and Assistance Program Grant application.

FUNDING

County Dollars = \$0

Other Sources & Amounts =

= \$

TOTAL

= \$0

FISCAL IMPACT

None

Included in current budget

Budget amendment requested

Other:

Related Financial Comments: If granted, this grant will result in \$150,000 per year for each of 2 years (\$300,000) to be utilized by Carver and Scott Counties to help meet the goal of diminishing homelessness in both counties.

Reviewed by Division Director

Date:

CARVER COUNTY REQUEST FOR BOARD ACTION

AGENDA ITEM: *Proclamation*

Item Name : National Public-Safety Telecommunications Week April 8-14, 2007

Originating Department: Sheriff's

Agenda Date: April 10, 2007

Amount of Time Requested: 5 minutes

Supp. Doc. Attached (y/n): Y

Previous County Board Action, If Any (include other parties which were advised, if any):

Item Type (✓ Only One): Consent _____ Regular Session X Discussion Session

EXPLANATION OF AGENDA ITEM (Include a description of background and benefits)

April 8-14th is National Public-Safety Telecommunications Week. The week has been designated to recognize and honor the men and women who provide the vital link between those in need of help and our Police-Fire-EMS responders.

Please acknowledge the 9-1-1 Telecommunicators (Dispatchers) of Carver County to show your appreciation to these HEROES for their special week!

RECOMMENDATIONS/BOARD ACTION/MOTION REQUESTED (Include motion in proper format)

See attached Resolution.

FINANCIAL IMPLICATIONS

Funding:

County Dollars	=		\$
Other Sources & Amounts	=		\$
_____	=		\$
_____	=		\$
TOTAL			≡\$

Budget Information (✓ appropriate items):

Budgeted:
 Not Budgeted:
 Amendment Required:
 (requires controller approval)

Related Financial Comments:

REVIEWS AND APPROVALS AS REQUIRED

✓ All Reviews and Approvals Received:

County Attorney _____ Risk Management _____ Human Resources _____ Controller _____ Other _____

Sheriff Byron 'Bud' Olson, by Manager Pamela Raser _____ March 28, 2007
DEPARTMENT HEAD APPROVAL (Signature) Date

Admin. Dept. Use Only: Approved _____ Denied _____ Tabled _____ Other _____

WHEREAS, Carver County's dedicated 9-1-1 dispatchers serve the citizens of the Carver County area 24 hours a day, 7 days a week, by answering calls for police, fire and emergency medical services, by coordinating and dispatching the appropriate public safety assistance as quickly as possible; and

WHEREAS, professional 9-1-1 dispatchers work to improve the emergency response capability of these communications systems through their dedication, leadership, training and participation in related public safety activities that enhance 9-1-1 services; and

WHEREAS, the services and functions performed by 9-1-1 dispatchers is a vital link between our citizens and our emergency services providers; and

WHEREAS, the week of April 8-14, 2007 has been set aside nation-wide to recognize 9-1-1 telecommunicators, call takers and dispatchers for the crucial role they play in the protection of life and property for all citizens.

NOW, THEREFORE, BE IT RESOLVED that we, the Carver County Board of Commissioners, do hereby acknowledge the week of April 8 -14, 2007 as

“Public-Safety Telecommunicators Week”

in Carver County in honor and recognition of the valuable contribution made by our 9-1-1 Dispatchers to the safety and well being of our citizens.

Gayle Degler, Chair
Carver County
Board of Commissioners

April 10, 2007



REQUEST FOR BOARD ACTION

AGENDA ITEM: Wm. Mueller & Son's request to amend existing mining operation.

Originating Division: Land & Water Services

Meeting Date: April 10, 2007

Amount of Time Requested: 1.0

Attachments for packet: Yes No

Item Type: Consent Regular Session Closed Session Work Session Ditch/Rail Authority

BACKGROUND/EXPLANATION OF AGENDA ITEM:

File #PZ20070005. Currently, Wm. Mueller & Son's, Inc. operate a mining activity located on the Paul & Jeanna Lundquist property in Section 35, Dahlgren Township. The Planning Commission recommended approval of the request by Wm. Mueller & Son's to amend the existing Conditional Use Permit (Order #PZ20030068) to include the processing of Class 5 material (subject to final access approval - See Memo Attached). The processed material will be utilized on the MN State Hwy 312 project and possibly the Carver County 10 reconstruction project. Both projects are set to be completed approximately Fall/Winter of 2008. After the two (2) projects are completed, the processing activity taking place on the Lundquist site would cease, and the mining activity would continue to operate under the previously approved conditions. The hauling to and from the site will be handled by contractor's working on either project. Access would remain via Co Rd 40 and Wm. Mueller & Son's Inc. has agreed to widen the entrance as well as construct a west bound by-pass lane at the pit location. A \$50,000 performance surety will need to be maintained for the operation. Dahlgren Township supports the request.

ACTION REQUESTED:

A motion adopting Findings of Fact and issuing Order #PZ20070005 for the issuance of a Conditional Use Permit.

FUNDING

County Dollars = \$-0-

Other Sources & Amounts = -0-

= \$

TOTAL = \$-0-

Related Financial Comments:

FISCAL IMPACT

None

Included in current budget

Budget amendment requested

Other:

Reviewed by Division Director

Date: 30 March 07

COUNTY OF CARVER
PLANNING COMMISSION RESOLUTION

FILE #: PZ20070005

RESOLUTION #: 07-09

WHEREAS, the following application for a Conditional Use Permit has been submitted and accepted:

FILE #: PZ20070005

APPLICANT: Wm. Mueller & Sons, Inc. (Mori Willemsen)

OWNER: Paul & Jeanne Lundquist

SITE ADDRESS: 15125 Co Rd 40

PERMIT TYPE: Mining and/or Land Reclamation

PURSUANT TO: County Code, Chapter 152, Section(s) 152.080 C4

LEGAL DESCRIPTION: See attached Exhibit "A"

PARCEL #: 04-035-0400

WHEREAS, said application was duly considered at a public hearing held by the Carver County Planning Commission at its regular meeting of March 20, 2007; and,

WHEREAS, the Carver County Planning Commission finds as follows:

1. Wm. Mueller & Sons, Inc. operate a mining operation on the Lundquist property (approximately 20 acres) located in the Northeast Quarter (NE¼) of Section 35, Dahlgren Township. The property is located in the Agricultural Zoning District, the Agricultural Preservation Program (until 2011), and the CCWRMA (Bevens Creek).
2. On December 1, 2003, Conditional Use Permit (Order #PZ20030068) was issued to Wm. Mueller & Sons, Inc. for the mining of aggregate on this property. The amount of material (sand & gravel) being excavated and hauled from the site was approved for up to a maximum of 50,000 cubic yards per year.
3. Wm. Mueller & Sons, Inc. is requesting to amend the existing Conditional Use Permit (Order #PZ20030068) which would include the processing of Class 5 material which will be utilized on the MN State Hwy 312 project (currently underway) and possibly the Carver County 10 project (beginning Spring/Summer 2007). Both projects are set to be completed approximately Fall/Winter of 2008. The processing on the Lundquist site will be done by a company called Intech, Inc. The hauling of material to and from the site will be handled by Zumbro River Constructors (ZRC), Ames Construction, Wm. Mueller & Sons and independent contractors working on the two (2) projects. After the State Hwy 312 and C.S.A.H 30 projects are completed, the processing activity taking place on the Lundquist site would cease, and the mining activity would continue to operate under the previously approved conditions.
4. Section 152.080 C4 of the Carver County Zoning Code (LARGE SCALE ACTIVITIES WITH UNIQUE LAND OR LOCATION NEEDS) allows for mining as a Conditional Use Permit.
5. Based on the previous permit, the mining operation primarily involves a front-end loader or backhoe with the intention of excavating and hauling up to 50,000 cubic yards of material (sand & gravel) per year. The hours of operation are 7:00 a.m. to 4:00 p.m. Monday through Friday, except operations may extend beyond these hours for occasional short-term projects or emergencies provided the Permittee notifies the County Land Management Department and Dahlgren Township prior to the project(s). **The temporary processing activity (crushing) would be done within the existing approved operational area and would consist of hours from 6:00 a.m. to 7:00 p.m. during peak production. In addition, the applicant is**

requesting the trucks (common to have 35-45 w/an average of 40-60 minute round trips) be allowed to haul material out from 7:00 a.m. to 7:00 p.m. Monday through Saturday. All truck hauling will cease if East Union Lutheran Church has a function (wedding, funeral, etc.). The processing crew would consist of 3 or 4 men and two (2) front-end loaders which will charge the processing equipment and load trucks. The crew has a portable trailer where all tools, oil, fuel and generator(s) are stored. Accurate quantities of material needed for the two (2) projects are not known at this time; however, realistic numbers could be in the 150,000 to 200,000 cubic yard range. After the State Hwy 312 & Co Rd 10 projects are completed, the processing activity will cease and the mining activity will resume as originally approved.

6. Access to the site would remain via an existing field entrance to Co Rd 40, which was approved as part of the original Conditional Use Permit. In 2003, Carver County Public Works reviewed and approved the field access location for site distances; however, the suitability of the access for the mining operation as it pertains to width, strength, etc. was not to be determined by Public Works. Based on the 2003 operational plan, there would be about 16 days of heavy hauling per year (e.g. 240 loads x 13 yards each x 16 days = 50,000 yards). That access location has been upgraded to a bituminous entrance leading down to the mining activity. The proposed haul route for the State Hwy 312 project would typically consist of Co Rd 40, Co Rd 147 and onto the Hwy 312 project. The haul route for the Co Rd 10 project has not been determined; however, Co Rd 40 and Co Rd 43 seem to be logical roads.
7. The County Public Works Department submitted a memo (dated: 3/14/07) addressing concerns about safety of the motoring public on this roadway when hauling operations are occurring. They recommended that a traffic study be completed to determine impacts to traffic and include a recommendation on potential safety measures, such as turn lane construction, bypass lane construction, signage plans, etc that could be installed or used to mitigate the traffic impacts caused by this hauling. After further review and discussion, the Planning Commission recommends approval of the request and further recommended the item not be placed on the County Board agenda until Wm. Mueller & Sons addresses the concerns noted in the Public Works memo.
8. As part of the 2003 CUP approval, the County Water Rules required a formal erosion control plan and stormwater management plan for an operation of 5 acres or more (Level 3). Also, impacts within 100' of sensitive areas would fall into this category. There are a couple wetland areas to the west of the proposed operational area that needed to be protected. The applicant retained an engineer to prepare plans and calculations, which were reviewed and approved by SWCD and/or Wenck Assoc. **No changes to the actual operational area are taking place; therefore, the amendment will conform to the County Water Management Rules.**
9. The relatively small size and limited scope of the operation should minimize the potential for adverse environmental effects. The pit would be expanded in an easterly direction with about 1 to 1½ acres being added per year (e.g. 100' x 600'). The applicant indicated that the pit may only be active for 8 to 10 years because of possible City development and the expiration of the Ag Preserve Covenant in 2011. The estimated depth of excavation along the hillside would be about 25 to 30 feet. The profile consists of about 1½' topsoil; 5½' clay; and 20' useable aggregate. The clay would likely be stockpiled along the southwesterly side of the site and the topsoil would be incorporated into the plow ground or stockpiled at the edge of the field. As excavation progresses it may be possible to stage restoration, using the stockpiled material, along the west side of the area that is being actively mined.
10. The Carver SWCD (Chip Hentges) reviewed the site regarding erosion control, wetlands, stormwater runoff and restoration. Erosion control should be fairly straightforward. A sand filter berm should be utilized to control runoff toward the wetland. Restoration would require grading at a 5:1 slope for land that would be returned to ag production and 3:1 elsewhere (minimum of 4" of topsoil). An NPDES (MPCA permit) was required, which specifies a rock entrance to assure that sediment does not leave the site, among other standards. Seeding & mulching would be required for the stockpiles and restored areas. He also suggested that staging of restoration might be possible after the third year. SWCD would continue to provide technical assistance on these matters.
11. The Dahlgren Town Board reviewed and recommended approval of the amended request on February 21, 2007.

THEREFORE, BE IT RESOLVED, THAT The Carver County Planning Commission hereby recommends the issuance of Conditional Use Permit #PZ20070005 on the subject permit on the land described in Exhibit "A" of the permit application. The Planning Commission further recommends the item not be placed on the County Board agenda until Wm. Mueller & Sons addresses the concerns noted in the Public Works memo (dated: March 14, 2007). If approved by the County Board, this permit shall Terminate and Supercede the prior approved Conditional Use Permit #PZ20030068. The Planning Commission further recommends that the following conditions be attached to the permit:

1. The permit is subject to compliance review. A change in ownership, operations or operator shall be cause for the permit to be reviewed by the Land Management Department for a determination as to whether an application for an amendment or similar consideration is necessary. Proposed owners and/or operators are encouraged to contact the County Land Management Department as early on in the timeline of the proposed change as possible.
2. The mining operation shall conform in accordance with the letter, dated 10/27/03, and the approved site plans, dated 11/05/03. The hours of operation shall be from 7:00 a.m. to 4 p.m. Monday through Friday, except operations may extend beyond these hours for occasional short-term projects and/or emergencies provided the Permittee notifies the County Land Management Department and Dahlgren Township, prior to the project(s).
3. The temporary processing activity, being conducted on the site by Intech, Inc., shall conform in accordance with the letter dated 2/20/07, and approved site plan, dated 2/20/07. The amended temporary processing activity (crushing) would be done within the existing approved operational area and would consist of hours from 6:00 a.m. to 7:00 p.m. during peak production. In addition, the applicant is requesting the trucks (common to have 35-45 w/an average of 40-60 minute round trips) be allowed to haul material out from 7:00 a.m. to 7:00 p.m. Monday through Saturday. All truck hauling will cease if East Union Lutheran Church has a function (Wedding, Funeral, etc.). The processing crew would consist of 3 or 4 men and two (2) front-end loader which will charge the processing equipment and load trucks. The crew has a portable trailer where all tools, oil, fuel and generator(s) are stored. After the State Hwy 312 & Co Rd 10 projects are completed, the processing activity will cease and the mining activity will resume with the originally approved conditions. Therefore, once the processing for the above mentioned projects is completed, this condition is no longer authorized and shall become Null and Void.
4. Permittee must obtain Co Rd 40 access approval and maintain the mining access and signage according to Public Works' requirements. Mining and/or similar disturbance shall not occur within 40 feet of the public right-of-way.
5. This request shall not be placed on the County Board agenda until Wm. Mueller & Sons addresses the concerns noted in the Public Works memo (dated: March 14, 2007).
6. A Grading Plan (including restoration), Erosion/Sediment Control Plan and Stormwater Management Plan shall be prepared and implemented in accordance with the Carver County Water Management Plan before mining commences. Permittee shall obtain an NPDES permit as required by the MPCA.
7. Stockpiles and restored areas must be seeded and disc mulched within 72 hours of final grading. Weeds and other unsightly vegetation shall be cut and/or sprayed as necessary to present a neat appearance and so as to prevent seeding of adjacent properties.
8. In the event that internal access roads are used to the extent that dust becomes a problem for surrounding properties, the access roads shall be treated with water or other similar dust control measures. Water oil SHALL not be used.
9. All storage of equipment and materials used in the operation shall be kept within the interior of the mining area so as to minimize visual exposure to areas outside the mining area. If applicable, appropriate screening shall be implemented.
10. Noise pollution shall be kept to the requirements/standards of the Minnesota State Statute.
11. No trash, garbage, waste, construction debris, or other similar materials shall be deposited in or near the permitted area.

12. Please notify SWCD and/or the Carver County Land Management Department 24 hours prior to beginning any processing activities. (The Carver SWCD will be monitoring the site and the County will be enforcing implementation of the erosion and sediment control measures.)

OPERATIONAL REQUIREMENTS:

These requirements combined with the Site/Operational Plan shall govern the mining operation.

1. The operation shall be conducted so that the required material can be removed while disturbing a minimal area and to permit restoration at the earliest possible time.
2. The Permittee shall confine mining operations as much as possible to one area at a time or to minimum areas required to obtain the proper materials required for blending. Exploration may be conducted in un-mined areas, but actual mining shall consist only under the conditions of this permit. Exploration shall consist only of boring or excavation required to determine extent and quality of the resource; material disturbed during exploration shall not be processed or removed until actual mining has begun.
3. Permittee shall maintain erosion control measures including, but not limited to, a sand filter berm near the wetland to ensure erosion and sedimentation do not occur. Permittee must maintain existing vegetation wherever possible and implement erosion control as required by the County Water Rules permit.
4. Existing drainage patterns shall not be altered if possible; if alteration is unavoidable, the alteration shall not adversely affect surrounding properties and/or cause erosion or sedimentation.
5. Topsoil and overburden required for restoration shall be maintained and shall be preserved from erosion or other loss. Only material necessary for restoration may be hauled to the site. Said material shall be incorporated into site restoration immediately or stockpiled according to the site plan.
6. Vertical faces shall be kept to a minimum except during the actual mining operation. Mining below the water level is not allowed.
7. The material removed pursuant to this permit is not expected to exceed 50,000 cubic yards per calendar year. The volume will be reviewed by the Land Management Administrator during review. The permit must be amended if the Land Management Administrator determines that the size and/or intensity of the operation exceeds the scope of the permit.

RESTORATION

1. The design of the restored areas must be according to standards of the Zoning Code and the Carver Water Management Rules. To the extent possible, restoration shall be staged (beginning in about the 3rd year) such that the exhausted areas along the westerly side of the operation are stabilized & turf established. Said design may be subject to revisions and modifications by the Land Management Department and Carver SWCD.

PERFORMANCE SECURITIES & INSURANCE

1. Permittee shall provide a performance security in a form acceptable to the County, naming the County as obligee. The security shall be drafted so as to be effective for at least 3 months after the annual anniversary dated of this point.
2. **PERFORMANCE SECURITY REQUIRED FOR THIS PERMIT - \$50,000.**
3. The conditions of the surety shall be that if the Permittee fails to conform to any of the conditions or requirements of this permit or for any reason ceases to operate the facility in accordance with the provisions of this permit and the County is required to expend monies, labor, or material to bring the operation into conformance with the permit or to

perform restoration as provided in this permit due to non-performance by the Permittee, the County may utilize the performance security for reimbursement for any and all expenses incurred to remedy such failure of the Permittee.

4. The obligor and its sureties hereby indemnify and save the County harmless from all losses, costs, and charges that may occur to the County because of default.
5. The Permittee shall furnish to the County a Certificate of Insurance providing coverage by an insurance company duly licensed by the State of Minnesota indicating that the Permittee has in force coverage for public liability, vehicle liability, loading and unloading, completed operations liability, explosion and collapse of underground operations liability, and bodily injury liability in the amount of at least \$1,000,000 for injury of any one person in any one occurrence. Property damage insurance coverage shall be in force with a minimum amount of at least \$1,000,000. Further, the Permittee shall furnish proof of workman's compensation coverage. Insurance certificate(s) described above shall carry an irrevocable notice to the County by the carrier 30 days prior to any change, modification, lapse, or cancellation of the policies required.
6. Insurance coverage required above shall be kept in effect for the duration of the permit. If the permit is to be terminated, insurance shall be maintained until the completion of restoration and return of the performance security.

ADOPTED by the Carver County Planning Commission this 20th day of March, 2007.

Gene Miller
Planning Commission Chair

WM. MUELLER & SONS INC.

ROAD CONTRACTORS • WASHED SAND & GRAVEL • LIMESTONE PRODUCTS • REDI-MIX BLACKTOP - BLACKTOP SURFACING

831 PARK AVE.
P.O. BOX 247
HAMBURG, MN 55339
PHONE 952-467-2720
FAX 952-467-3894

Date: March 29, 2007

To: Bill Weckman,
Assistance County Engineer

From: Richard Smith,
Wm. Mueller & Sons, Inc.

Subject: Pit entrance and traffic flow at the Paul Lindquist property on CSAH #40

In regards to the CUP amendment on this property and traffic concerns that may arise, Wm. Mueller and Sons would propose to widen the entrance and construct a bypass lane on CSAH #40. Due to existing right of way restrictions, exact dimensions will need to be determined in the field. We request that your office assist in this matter. Design thickness will be constructed to county specs.

Thank you.

Wm. Mueller & Sons, Inc.

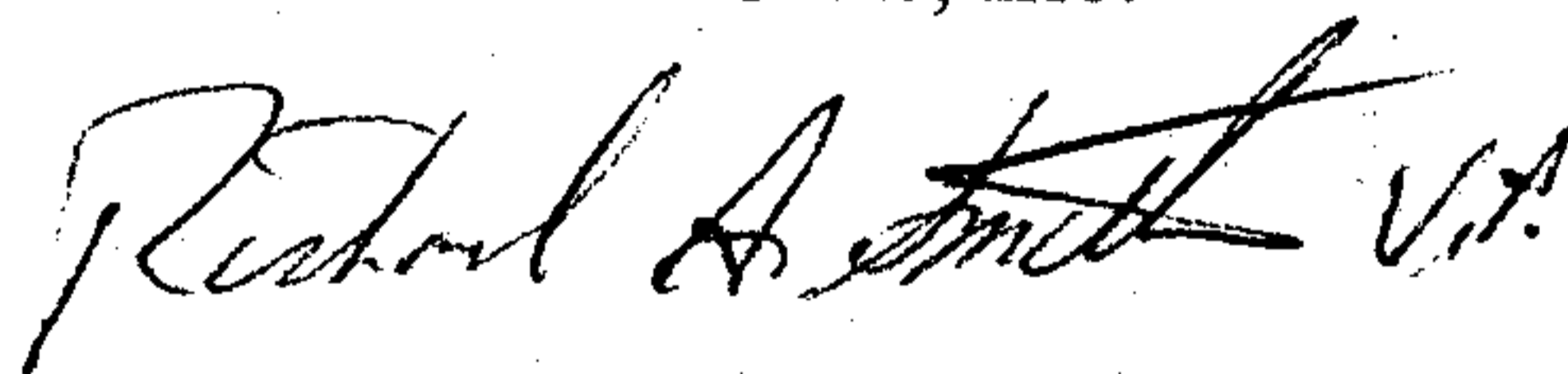

Richard A. Smith,

Vice President

Dahlgren Township

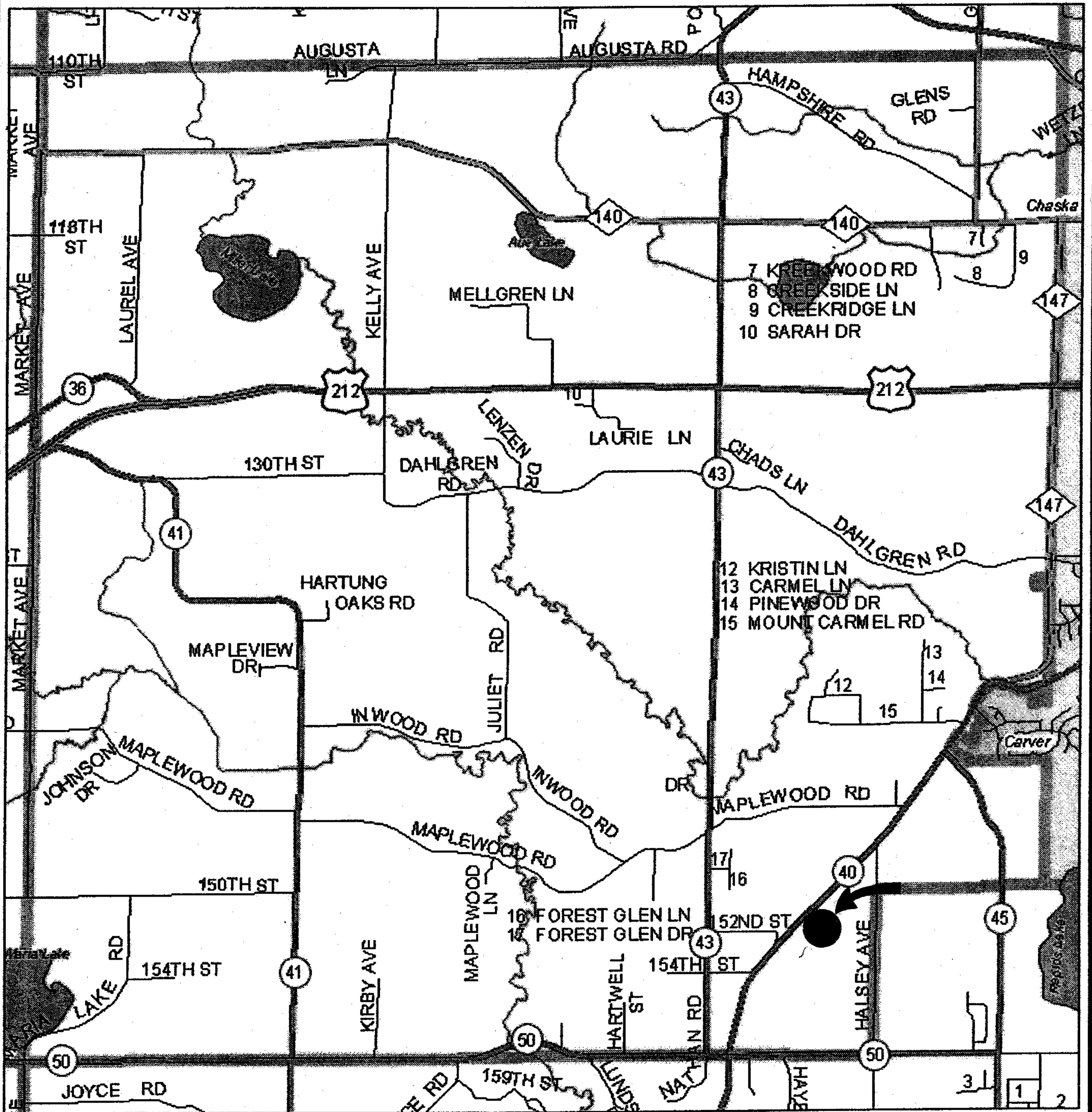

This map was created using Carver County's Geographic Information Systems (GIS). It is a compilation of information and data from various City, County, State, and Federal offices. This map is not a surveyed or legally recorded map and is intended to be used as a reference. Carver County is not responsible for any inaccuracies contained herein.



Map Created by Carver County GIS
Apr 21, 2006

**COUNTY OF CARVER
BOARD OF COMMISSIONERS**

**AN ORDER FINDING CERTAIN FACTS AND ORDERING
THE ISSUANCE OF A CONDITIONAL USE PERMIT**

DATE: April 10, 2007

ORDER #: PZ20070005

FILE #: PZ20070005

APPLICANT: Wm. Mueller & Sons, Inc. (Mori Willemsen)

OWNER: Paul & Jeanne Lundquist

SITE ADDRESS: 15125 Co Rd 40

PERMIT TYPE: Mining and/or Land Reclamation

PURSUANT TO: County Code, Chapter 152, Section(s) 152.080 C4

LEGAL DESCRIPTION: See attached Exhibit "A"

PARCEL #: 04-035-0400

A public hearing was held on this matter on March 20, 2007, by the Carver County Planning Commission, and the recommendation of the Planning Commission was duly considered in the issuance of this order.

FINDINGS OF FACT

1. Wm. Mueller & Sons, Inc. operate a mining operation on the Lundquist property (approximately 20 acres) located in the Northeast Quarter (NE¹/₄) of Section 35, Dahlgren Township. The property is located in the Agricultural Zoning District, the Agricultural Preservation Program (until 2011), and the CCWRMA (Bevens Creek).
2. On December 1, 2003, Conditional Use Permit (Order #PZ20030068) was issued to Wm. Mueller & Sons, Inc. for the mining of aggregate on this property. The amount of material (sand & gravel) being excavated and hauled from the site was approved for up to a maximum of 50,000 cubic yards per year.
3. Wm. Mueller & Sons, Inc. is requesting to amend the existing Conditional Use Permit (Order #PZ20030068) which would include the processing of Class 5 material which will be utilized on the MN State Hwy 312 project (currently underway) and possibly the Carver County 10 project (beginning Spring/Summer 2007). Both projects are set to be completed approximately Fall/Winter of 2008. The processing on the Lundquist site will be done by a company called Intech, Inc. The hauling of material to and from the site will be handled by Zumbro River Constructors (ZRC), Ames Construction, Wm. Mueller & Sons and independent contractors working on the two (2) projects. After the State Hwy 312 and C.S.A.H 30 projects are completed, the processing activity taking place on the Lundquist site would cease, and the mining activity would continue to operate under the previously approved conditions.
4. Section 152.080 C4 of the Carver County Zoning Code (LARGE SCALE ACTIVITIES WITH UNIQUE LAND OR LOCATION NEEDS) allows for mining as a Conditional Use Permit.
5. Based on the previous permit, the mining operation primarily involves a front-end loader or backhoe with the intention of excavating and hauling up to 50,000 cubic yards of material (sand & gravel) per year. The hours of operation are 7:00 a.m. to 4:00 p.m. Monday through Friday, except operations may extend beyond these hours for occasional short-term projects or emergencies provided the Permittee notifies the County Land Management Department and Dahlgren Township prior to the project(s). **The temporary processing activity (crushing) would be done within the existing approved operational area and would consist of hours from 6:00 a.m. to 7:00 p.m. during peak production. In addition, the applicant is requesting the trucks (common to have 35-45 w/an average of 40-60 minute round trips) be allowed to haul material**

out from 7:00 a.m. to 7:00 p.m. Monday through Saturday. All truck hauling will cease if East Union Lutheran Church has a function (wedding, funeral, etc.). The processing crew would consist of 3 or 4 men and two (2) front-end loaders which will charge the processing equipment and load trucks. The crew has a portable trailer where all tools, oil, fuel and generator(s) are stored. Accurate quantities of material needed for the two (2) projects are not known at this time; however, realistic numbers could be in the 150,000 to 200,000 cubic yard range. After the State Hwy 312 & Co Rd 10 projects are completed, the processing activity will cease and the mining activity will resume as originally approved.

6. Access to the site would remain via an existing field entrance to Co Rd 40, which was approved as part of the original Conditional Use Permit. In 2003, Carver County Public Works reviewed and approved the field access location for site distances; however, the suitability of the access for the mining operation as it pertains to width, strength, etc. was not to be determined by Public Works. Based on the 2003 operational plan, there would be about 16 days of heavy hauling per year (e.g. 240 loads x 13 yards each x 16 days = 50,000 yards). That access location has been upgraded to a bituminous entrance leading down to the mining activity. The proposed haul route for the State Hwy 312 project would typically consist of Co Rd 40, Co Rd 147 and onto the Hwy 312 project. The haul route for the Co Rd 10 project has not been determined; however, Co Rd 40 and Co Rd 43 seem to be logical roads.
7. Wm. Mueller & Son's Inc. has agreed to widen the entrance and construct a west bound by-pass lane at the pit location. Due to existing right-of-way restrictions, exact dimensions will need to be determined in the field. **Note:** Attached for your review is the brief letter (dated: 3/29/07) submitted by Wm. Mueller & Son's, Inc.
8. As part of the 2003 CUP approval, the County Water Rules required a formal erosion control plan and stormwater management plan for an operation of 5 acres or more (Level 3). Also, impacts within 100' of sensitive areas would fall into this category. There are a couple wetland areas to the west of the proposed operational area that needed to be protected. The applicant retained an engineer to prepare plans and calculations, which were reviewed and approved by SWCD and/or Wenck Assoc. **No changes to the actual operational area are taking place; therefore, the amendment will conform to the County Water Management Rules.**
9. The relatively small size and limited scope of the operation should minimize the potential for adverse environmental effects. The pit would be expanded in an easterly direction with about 1 to 1½ acres being added per year (e.g. 100' x 600'). The applicant indicated that the pit may only be active for 8 to 10 years because of possible City development and the expiration of the Ag Preserve Covenant in 2011. The estimated depth of excavation along the hillside would be about 25 to 30 feet. The profile consists of about 1½' topsoil; 5½' clay; and 20' useable aggregate. The clay would likely be stockpiled along the southwesterly side of the site and the topsoil would be incorporated into the plow ground or stockpiled at the edge of the field. As excavation progresses it may be possible to stage restoration, using the stockpiled material, along the west side of the area that is being actively mined.
10. The Carver SWCD (Chip Hentges) reviewed the site regarding erosion control, wetlands, stormwater runoff and restoration. Erosion control should be fairly straightforward. A sand filter berm should be utilized to control runoff toward the wetland. Restoration would require grading at a 5:1 slope for land that would be returned to ag production and 3:1 elsewhere (minimum of 4" of topsoil). An NPDES (MPCA permit) was required, which specifies a rock entrance to assure that sediment does not leave the site, among other standards. Seeding & mulching would be required for the stockpiles and restored areas. He also suggested that staging of restoration might be possible after the third year. SWCD would continue to provide technical assistance on these matters.
11. The Dahlgren Town Board reviewed and recommended approval of the amended request on February 21, 2007.
12. The Board has considered all the factors required by Section 152.251 of the Carver County Code and finds that all are either true in this case or can be mitigated by conditions placed on the permit.

IT IS HEREBY ORDERED THAT THE CARVER COUNTY ZONING ADMINISTRATOR SHALL ISSUE CONDITIONAL USE PERMIT #PZ20070005. THIS PERMIT IS ISSUED PURSUANT TO THE CARVER COUNTY CODE, SECTION(S) 152.080 C4 ON PROPERTY LEGALLY DESCRIBED IN EXHIBIT "A". THIS PERMIT SHALL TERMINATE AND SUPERCEDE THE PRIOR APPROVED CONDITIONAL USE PERMIT #PZ20030068. THE FOLLOWING CONDITIONS SHALL BE ATTACHED TO THE PERMIT:

1. The permit is subject to compliance review. A change in ownership, operations or operator shall be cause for the permit to be reviewed by the Land Management Department for a determination as to whether an application for an amendment or similar consideration is necessary. Proposed owners and/or operators are encouraged to contact the County Land Management Department as early on in the timeline of the proposed change as possible.
2. The mining operation shall conform in accordance with the letter, dated 10/27/03, and the approved site plans, dated 11/05/03. The hours of operation shall be from 7:00 a.m. to 4 p.m. Monday through Friday, except operations may extend beyond these hours for occasional short-term projects and/or emergencies provided the Permittee notifies the County Land Management Department and Dahlgren Township, prior to the project(s).
3. The temporary processing activity, being conducted on the site by Intech, Inc., shall conform in accordance with the letter dated 2/20/07, and approved site plan, dated 2/20/07. The amended temporary processing activity (crushing) would be done within the existing approved operational area and would consist of hours from 6:00 a.m. to 7:00 p.m. during peak production. In addition, the applicant is requesting the trucks (common to have 35-45 w/an average of 40-60 minute round trips) be allowed to haul material out from 7:00 a.m. to 7:00 p.m. Monday through Saturday. All truck hauling will cease if East Union Lutheran Church has a function (Wedding, Funeral, etc.). The processing crew would consist of 3 or 4 men and two (2) front-end loader which will charge the processing equipment and load trucks. The crew has a portable trailer where all tools, oil, fuel and generator(s) are stored. After the State Hwy 312 & Co Rd 10 projects are completed, the processing activity will cease and the mining activity will resume with the originally approved conditions. Therefore, once the processing for the above mentioned projects is completed, this condition is no longer authorized and shall become Null and Void.
4. Permittee must obtain Co Rd 40 access approval and maintain the mining access and signage according to Public Works' requirements. Mining and/or similar disturbance shall not occur within 40 feet of the public right-of-way. Permittee must construct a west bound by-pass lane and widen the existing access in order to handle the additional truck traffic. (As indicated in the March 29, 2007, letter submitted by Wm. Meuller & Son's, Inc.) All access upgrades must be authorized by the Carver County Public Works Department prior to beginning any construction activity.
5. A Grading Plan (including restoration), Erosion/Sediment Control Plan and Stormwater Management Plan shall be prepared and implemented in accordance with the Carver County Water Management Plan before mining commences. Permittee shall obtain an NPDES permit as required by the MPCA.
6. Stockpiles and restored areas must be seeded and disc mulched within 72 hours of final grading. Weeds and other unsightly vegetation shall be cut and/or sprayed as necessary to present a neat appearance and so as to prevent seeding of adjacent properties.
7. In the event that internal access roads are used to the extent that dust becomes a problem for surrounding properties, the access roads shall be treated with water or other similar dust control measures. Water oil SHALL not be used.
8. All storage of equipment and materials used in the operation shall be kept within the interior of the mining area so as to minimize visual exposure to areas outside the mining area. If applicable, appropriate screening shall be implemented.
9. Noise pollution shall be kept to the requirements/standards of the Minnesota State Statute.
10. No trash, garbage, waste, construction debris, or other similar materials shall be deposited in or near the permitted area.

11. Please notify SWCD and/or the Carver County Land Management Department 24 hours prior to beginning any processing activities. (The Carver SWCD will be monitoring the site and the County will be enforcing implementation of the erosion and sediment control measures.)

OPERATIONAL REQUIREMENTS:

These requirements combined with the Site/Operational Plan shall govern the mining operation.

1. The operation shall be conducted so that the required material can be removed while disturbing a minimal area and to permit restoration at the earliest possible time.
2. The Permittee shall confine mining operations as much as possible to one area at a time or to minimum areas required to obtain the proper materials required for blending. Exploration may be conducted in un-mined areas, but actual mining shall consist only under the conditions of this permit. Exploration shall consist only of boring or excavation required to determine extent and quality of the resource; material disturbed during exploration shall not be processed or removed until actual mining has begun.
3. Permittee shall maintain erosion control measures including, but not limited to, a sand filter berm near the wetland to ensure erosion and sedimentation do not occur. Permittee must maintain existing vegetation wherever possible and implement erosion control as required by the County Water Rules permit.
4. Existing drainage patterns shall not be altered if possible; if alteration is unavoidable, the alteration shall not adversely affect surrounding properties and/or cause erosion or sedimentation.
5. Topsoil and overburden required for restoration shall be maintained and shall be preserved from erosion or other loss. Only material necessary for restoration may be hauled to the site. Said material shall be incorporated into site restoration immediately or stockpiled according to the site plan.
6. Vertical faces shall be kept to a minimum except during the actual mining operation. Mining below the water level is not allowed.
7. The material removed pursuant to this permit is not expected to exceed 50,000 cubic yards per calendar year. The volume will be reviewed by the Land Management Administrator during review. The permit must be amended if the Land Management Administrator determines that the size and/or intensity of the operation exceeds the scope of the permit.

RESTORATION

1. The design of the restored areas must be according to standards of the Zoning Code and the Carver Water Management Rules. To the extent possible, restoration shall be staged (beginning in about the 3rd year) such that the exhausted areas along the westerly side of the operation are stabilized & turf established. Said design may be subject to revisions and modifications by the Land Management Department and Carver SWCD.

PERFORMANCE SECURITIES & INSURANCE

1. Permittee shall provide a performance security in a form acceptable to the County, naming the County as obligee. The security shall be drafted so as to be effective for at least 3 months after the annual anniversary dated of this point.
2. PERFORMANCE SECURITY REQUIRED FOR THIS PERMIT - \$50,000.
3. The conditions of the surety shall be that if the Permittee fails to conform to any of the conditions or requirements of this permit or for any reason ceases to operate the facility in accordance with the provisions of this permit and the County is required to expend monies, labor, or material to bring the operation into conformance with the permit or to

perform restoration as provided in this permit due to non-performance by the Permittee, the County may utilize the performance security for reimbursement for any and all expenses incurred to remedy such failure of the Permittee.

4. The obligor and its sureties hereby indemnify and save the County harmless from all losses, costs, and charges that may occur to the County because of default.
5. The Permittee shall furnish to the County a Certificate of Insurance providing coverage by an insurance company duly licensed by the State of Minnesota indicating that the Permittee has in force coverage for public liability, vehicle liability, loading and unloading, completed operations liability, explosion and collapse of underground operations liability, and bodily injury liability in the amount of at least \$1,000,000 for injury of any one person in any one occurrence. Property damage insurance coverage shall be in force with a minimum amount of at least \$1,000,000. Further, the Permittee shall furnish proof of workman's compensation coverage. Insurance certificate(s) described above shall carry an irrevocable notice to the County by the carrier 30 days prior to any change, modification, lapse, or cancellation of the policies required.
6. Insurance coverage required above shall be kept in effect for the duration of the permit. If the permit is to be terminated, insurance shall be maintained until the completion of restoration and return of the performance security.

Gayle Degler, Chair
Carver County Board

Dave Hemze
County Administrator

THE STIPULATIONS OF THIS ORDER, IF ANY, SHALL BE SATISFIED WITHIN SIX (6) MONTHS OF THE DATE FIRST WRITTEN ABOVE, OR SAID ORDER SHALL BE NULL AND VOID AND THE CONDITIONAL USE PERMIT SHALL NOT BE ISSUED. THE SIX (6) MONTH DEADLINE MAY BE EXTENDED ONLY BY ACTION OF THE COUNTY BOARD OF COMMISSIONERS.



REQUEST FOR BOARD ACTION

AGENDA ITEM: Professional Services Agreement with eDocument Resources

Originating Division: Community Social Services

Meeting Date: 4/10/2007

Amount of Time Requested: 10'

Attachments for packet: Yes No

Item Type: Consent Regular Session Closed Session Work Session Ditch/Rail Authority

BACKGROUND/EXPLANATION OF AGENDA ITEM: As the volume of information and records has increased over time, the division has explored ways to effectively control and manage paper and electronic data. Community Social Services will be piloting in financial assistance, one of the areas that has the greatest amount of forms, files and information, an electronic document management system from eDocument Resources. This system, Compass/OnBase, is designed to give us far better control over the capture, storage, management, retrieval, and distribution of information.

By standardizing and automating key work processes, this system, which links directly to various DHS information systems, will help the entire department to run more efficiently and cost effectively. The Front Desk Document Capture feature will enable us to collect and scan documents immediately at both the reception and interview areas. The Online Forms Management feature will allow case workers and clients to fill out forms on-screen, automatically populating them with previously collected information, linking related documents, and capturing signatures electronically. Records will be stored in the proper section of a virtual case folder. This system will enable us to ultimately eliminate paper files from the department.

eDocument Resources will be providing project management assistance, implementation and ongoing support for this effort. Our Information Services department will be actively involved in the successful rollout of this project. The costs for this contract includes the necessary software, selected hardware, maintenance agreements, and professional services provided by eDocument Resources.

ACTION REQUESTED: Motion to approve Professional Services Agreement with eDocument Resources for the implementation of the Compass/OnBase electronic document management system.

FUNDING

County Dollars =	\$70417
Other Sources & Amounts =	
Federal	=\$170417
TOTAL	= \$340833

FISCAL IMPACT

None
 Included in current budget
 Budget amendment requested
 Other:

Related Financial Comments: \$155,000 of the county amount is covered from the year end savings, with \$15,417 from 2007 Tax Levy.

Reviewed by Division Director

Date: 3/28/2007



REQUEST FOR BOARD ACTION

AGENDA ITEM : Public Works headquarters storage project update

Originating Division: Administrative Services

Meeting Date: April 10, 2007

Amount of Time Requested: 20 Minutes

Attachments for packet: Yes No

Item Type: Consent Regular Session Closed Session Work Session Ditch/Rail Authority

BACKGROUND/EXPLANATION OF AGENDA ITEM: Facilities Services has been working with an architect (Architectural Alliance) to complete planning and predevelopment activities for the construction of additional vehicle and equipment storage needs at Public Works HQ. Public Works, the Sheriff's Office and other county departments have been involved in the development of programming, master planning, and architectural plans; all of which are complete. As of this writing, civil engineering is in process but is expected to be completed prior presentation of this board action. Competitive pricing shall be requested from suppliers after completion of the engineering plans.

This board action provides an update of a new semi-heated storage facility and added space to cold storage at PWHQ in Cologne. We anticipate both efforts can be accomplished with the \$654,000 budgeted for this effort.

The programming and master plan activities indicate construction of a new semi-heated 14,856 square foot metal building with a concrete floor and heated fresh (make up) air. The building design allows for the Sheriff's Emergency Response Team (SERT) vehicles to be moved from building area "C" of the main Public Works Facility to a new drive through space in the new storage building thus freeing up space for PW. Additionally, the new storage building will accommodate various specialty emergency vehicles as well as evidence storage.

While most of the immediate demand for the semi-heated space is being motivated by Law Enforcement and is initially being dedicated towards that use, exclusive use the space is not intended. Final use plans for the expanded cold storage is expected to be mainly of units from public works.

A goal achieved by the programming and master planning is the addition of vehicle parking for staff, service vehicles and equipment. Thirty two new stalls are programmed between the existing semi-heated building and proposed new structure allowing for a distance of sixty (60) feet between buildings. Should additional security be necessary, this area can be fenced and gated.

The cold storage facility is programmed to be expanded by the original plan amount of 7,136 square feet. Some site work will be needed to be addressed by our staff to accommodate adequate movement in and out of the new cold storage.

The primary issue associated with the project is the amount of site work necessary to accommodate the project and the amount of new bituminous necessary. Depending on the bids, portions of bituminous may have to be removed due to budget considerations and the use of in-house staff may be a consideration to support the additional site work. PW does have pile of recycled asphalt on site that maybe used to accommodate this project.

Planning submittals are expected at the time of this review. Planning staff has indicated that the preliminary plans, as presented, follows the conditions of the existing Conditional Use Permit and Master Plan thus no review by the Planning Commission is scheduled.

ACTION REQUESTED: No action requested by the Board until after general contractor bids are received and contracts are drawn up for approval.

FUNDING

County Dollars = \$
Other Sources & Amounts = \$

TOTAL =

FISCAL IMPACT

- None
- Included in current budget
- Budget amendment requested
- Other:

Related Financial Comments:

Report Date: April 3, 2007

Reviewed by Division Director

Date: 4/1/07

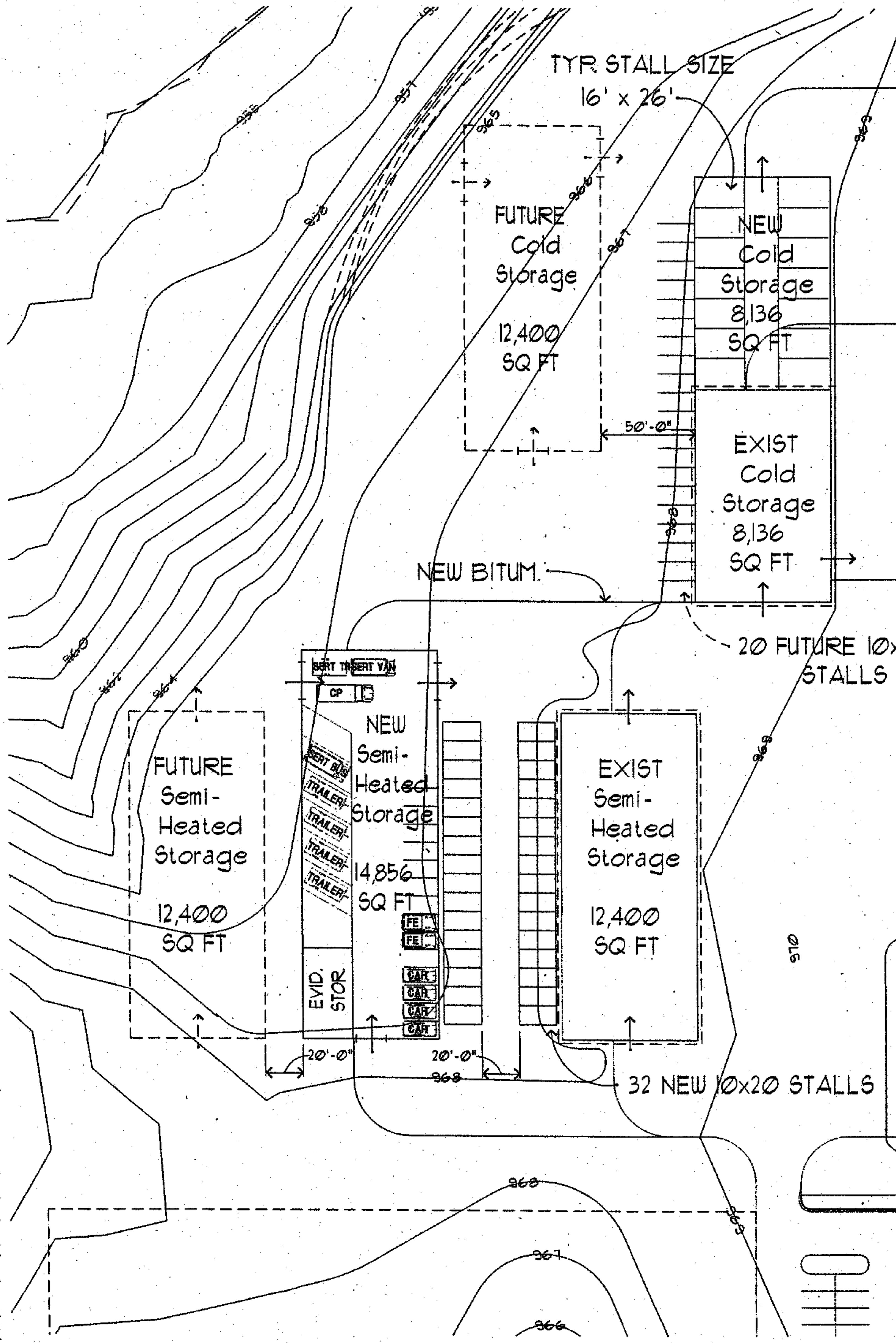

2007-02-21 2:07 PM
 User: p:\2007\2007016\carver\3-30\3-30\Plan\Master Plan OPT C.dwg
 2007-02-21 2:07 PM
 User: p:\2007\2007016\carver\3-30\3-30\Plan\Master Plan OPT C.dwg

Project **CARVER COUNTY PUBLIC WORKS**
 1" = 50'-0"
 Title **OPTION C**

 Comm. No. **2007018**
 Date **02.23.07**
 Drawing No. **OPT C**

ARCHITECTURAL ALLIANCE
 400 CLIFTON AVENUE SOUTH
 MINNEAPOLIS, MINNESOTA 55408-3299
 TEL (612) 871-5700 FAX (612) 871-7212