

Carver County Board of Commissioners  
 Regular Session  
 September 23, 2008  
 County Board Room  
 Carver County Government Center  
 Human Services Building  
 Chaska, Minnesota

PAGE

9:15 a.m.

1.     *a)     CONVENE*
- b)     Pledge of Allegiance*
- c)     Public participation (comments limited to five minutes)*
- d)     Introduction of New Employees*
2.     Agenda review and adoption
3.     Approve minutes of September 9, 2008 Regular Session ..... 1-3
4.     Community announcements

9:15 a.m.

5.     **CONSENT AGENDA**
- 5.1    Payment of emergency claims ..... 4-5
- 5.2    Approve school linked mental health contract and create  
       two therapist positions..... 6-7
- 5.3    Reinstate the Clinical Director position  
       from .8FTE to 1.0 FTE..... 8
- 5.4    Authorization to purchase Total Station for use by  
       Sheriff's crime lab ..... 9
- 5.5    Jail security upgrade ..... 10
- 5.6    Renewal application for on sale and Sunday liquor license for  
       Waconia Lakeside Inc., d/b/a Waconia Lakeside Ballroom .. 11
- 5.7    Renewal application for on-sale and Sunday liquor license for  
       Timber Creek Golf Course LLC ..... 12
- 5.8    Approval of out of state travel to SPSS training in New York 13
- 5.9    Fire alarm annual testing, fire sprinkler annual testing, fire  
       alarm monitoring and fire extinguisher annual testing ..... 14
- 5.10   Agreement for roofing work at Lake Minnewashta  
       Regional Park..... 15-16
- 5.11   Speed zone study requests ..... 17-18
- 5.12   Renewal application for on-sale, off-sale and Sunday  
       Liquor license for Hollywood Sports, LLC ..... 19
- 5.13   Layton Schlueter-home extended business ..... 20-23
- 5.14   Community Social Services' warrants ..... NO ATT
- 5.15   Commissioners' warrants..... SEE ATT

- 9:20 a.m.            **6.    SHERIFF**
  - 6.1    JPA with MN BCA and CIS contract amendment to develop  
         eCharging and NEIS software adaptors..... 24-25
  
- 9:30 a.m.            **7.    ADMINISTRATIVE SERVICES**
  - 7.1    Approve porous pavement alternate bid for North  
         Government Center parking lot ..... 26-28
  
- 9:35 a.m.            **ADJOURN REGULAR SESSION**
- 9:35 a.m.            1.    Chair
- 2.    Board Members
- 3.    Administrator
- 9:55 a.m.            4.    Adjourn

David Hemze  
County Administrator

### Work Session

- 9:55 a.m.            **1.    FINANCIAL SERVICES**
  - 1.1    High level overview: 2009 budget and  
         discretionary services..... 29-34

REGULAR SESSION  
September 9, 2009

A Regular Session of the Carver County Board of Commissioners was held in the County Government Center, Chaska, on September 9, 2008. Chair James Ische convened the session at 9:15 a.m.

Members present: James Ische, Chair, Tim Lynch, Vice Chair, Gayle Degler, Randy Maluchnik and Tom Workman.

Members absent: None.

The following amendment was made to the agenda:

Add 5.5 Application for Carver County Transit 2009 Funding Agreement with Metropolitan Council.

Degler moved, Lynch seconded, to approve the agenda as amended. Motion carried unanimously.

Workman moved, Maluchnik seconded, to approve the minutes of the September 2, 2008, Regular Session Motion carried unanimously.

Community announcements were made by the Board.

Degler moved, Lynch seconded, to approve the following consent agenda items:

Payment of emergency claim in the amount of \$207.98.

Approved the following abatements:

65-342-0220	William Klutes (2007, 2008)
30-263-1030	Diane Mclean
30-263-0250	Diane Mclean
30-263-1020	Diane Mclean
75-050-1790	Lorraine Kelzer (2006, 2007, 2008)
01-010-1500	David Rogers (2006, 2007, 2008)
25-554-0140	David Major

Approved submitting the application for 2009 State operating transit funds to the Metropolitan Council and authorized the County Administrator to sign the certifications signature page and the actual contract once it is received.

Community Social Services' actions.

Approved payment of the following Commissioners' warrants:

INSERT

Motion carried unanimously.

Steve Taylor, Administrative Services, appeared before the Board requesting authorization to enter into final negotiations with Jaguar Communications to install a fiber optic ring in Carver County. He introduced Fazil Bhimani, with AGL Consulting, who assisted with putting the project together. He noted staff also spent a lot of time over the past several months on the project and they had met with various consumer groups. Taylor stated they received positive feedback and the interest levels were high.

He pointed out the significant limitations with the County's current technology in place and the benefits of a fiber optic ring. Taylor reviewed the proposed layout of the fiber ring that encompassed approximately 70 miles and indicated it would be a fully redundant ring.

Taylor stated, after analyzing the requirements, a request for bid was developed. Following that a Selection Committee was formed and two vendors were interviewed. He stated the Selection Committee recommended moving forward with Jaguar Communications. Taylor indicated the Selection Committee talked about going from 48 to 72 fiber and they thought that was important for future expansion and flexibility. He explained the cost breakdown and indicated connecting smaller cities such as Hamburg and New Germany would require \$200,000 in additional costs. If the Board approved, engineered drawings would occur the balance of the year and they would be looking at construction taking place in April-May 2009 with completion most likely the spring of 2010.

The option to include the Cities of Hamburg and New Germany in the fiber optic ring was discussed.

David Hemze, County Administrator, stated the project has been a priority for the ACCEL group. He pointed out the concept of private/public ownership and the opportunities that existed.

The Board reviewed the cost breakdown between Jaguar Communications and the County and the cost share for relocations. The Board also discussed the private/public relationship and the benefits to each.

Hemze explained \$400,000 was budgeted in 2008 when they foresaw the problem and the funding source for completing the project was yet to be decided. He clarified they were asking for approval of the concept today and not asking for approval of the contract. Hemze acknowledged there were issues that still needed to be addressed and urged the Board to think about broader policy choices.

Maluchnik moved, Degler seconded, to direct the Administrative Services Division Director to enter into final negotiations with Jaguar Communications to install a fiber optic ring in Carver County and to direct staff to review the issues related to the cities of New Germany and Hamburg and determine possible avenues that might work. Degler, Ische, Lynch, Maluchnik voted aye. Workman voted nay. Motion carried.

REGULAR SESSION  
September 9, 2009

Workman moved, Lynch seconded, to adjourn the Regular Session at 10:45 a.m. Motion carried unanimously.

David Hemze  
County Administrator

(These proceedings contain summaries of resolutions. The full text of the resolutions are available for public inspection in the office of the county administrator.)



Office of Finance Director  
Carver County Government Center  
Administration Building  
600 East Fourth Street  
Chaska, MN 55318-1202  
Phone: 952 361-1509  
Fax: 952 361-1308

285553

AUTHORIZATION

PAYMENT OF EMERGENCY CLAIM

Motion passed by the Board of County Commissioners at their February 24, 1987 meeting has authorized the issuance of a check upon the consensus of the Chairman of the Board, County Administrator and the County Attorney (with a minimum of two).

VENDOR: Pat Burns

ACCOUNT: 6379

AMOUNT: \$ 316.67

REASON: Victim assistance

Department Head Signature: *James Keeler*

Chairman of County Board

James M. Ische

County Administrator

David Henze

*Finance Director*

County Attorney

*James W. Keeler, Jr.*  
James W. Keeler, Jr.

Date: 9/5/08



Office of Finance Director  
Carver County Government Center  
Administration Building  
600 East Fourth Street  
Chaska, MN 55318-1202  
Phone: 952 361-1509  
Fax: 952 361-1308

295552

AUTHORIZATION

PAYMENT OF EMERGENCY CLAIM

Motion passed by the Board of County Commissioners at their February 24, 1987 meeting has authorized the issuance of a check upon the consensus of the Chairman of the Board, County Administrator and the County Attorney (with a minimum of two).

VENDOR: WATERS EDGE TOWNHOMES  
ACCOUNT: 11-423-710-3440-1040  
AMOUNT: 196.00  
REASON: HOUSING ASSISTANCE - UNABLE TO PAY RENT  
Department Head Signature: Mary Bark

Chairman of County Board

James Ische

County Administrator

David Hemze

Finance Director

County Attorney

James W. Keeler, Jr.

Date: 9/5/88



# REQUEST FOR BOARD ACTION

## AGENDA ITEM : Approve School Linked Mental Health Contract and Create Two Therapist Positions

Originating Division: Community Social Services

Meeting Date: 9/23/2008

Amount of Time Requested: NA

Attachments for packet:  Yes  No

Item Type:  Consent  Regular Session  Closed Session  Work Session  Ditch/Rail Authority

**BACKGROUND/EXPLANATION OF AGENDA ITEM:** On May 6, 2008 the Board accepted the School Linked Mental Health Services Infrastructure Grant and authorized the Division to place the Contract, Budget Amendment and position creation on the Consent Agenda. The negotiations have been completed with the Department of Human Services and a contract has been finalized for the grant. The grant is a three year grant in the amount of \$270,000. It allows the Division to add two Therapists to the work in the Carver Scott Educational Cooperative Programs and complete the implementation of third party billing at the Coop.

**ACTION REQUESTED:** To approve the contract with the Department of Human Services for the School Linked Mental Health Services Infrastructure Grant.

To authorize the creation of two 1.0 FTE Therapists.

### FUNDING

County Dollars =	\$
Other Sources & Amounts =	\$270,000
	= \$
<b>TOTAL</b>	<b>= \$270.000</b>

### FISCAL IMPACT

None  
 Included in current budget  
 Budget amendment requested  
 Other:

Related Financial Comments:

Reviewed by Division Director

Date: 9/12/2008



# BUDGET AMENDMENT REQUEST FORM

**Submit to Finance Office one week prior to County Board Session.**

**DEPARTMENT: Community Social Services**

**Date of County Board Session:**

**Fund: 11**

Description of Revenue Account funds are to Increased/(Decreased):	Amount	Description of Expenditure Account funds are to Increased/(Decreased):	Amount
<u>2008 BUDGET</u>		<u>2008 BUDGET</u>	
Fees for Service	\$ 1,250	Salaries & Benefits	\$ 31,250
Special Education Aid	\$ 8,750	Professional Services	\$ 614
SLMHS Infrastructure Grant	\$ 29,302	Purchase of Services	\$ 375
		Material & Supplies	\$ 7,063
<b>TOTAL:</b>	<b>\$ 39,302</b>	<b>TOTAL:</b>	<b>\$ 39,302</b>

**A. Reason for Request:**

To recognize in the 2008 Budget the School Linked Mental Health Contract approved by the Board in their May 6th 2008 Board Meeting which is covered by School Linked Mental Health Services Infrastructure Grant from the State of Minnesota.

**B. Financial Impact: (To be filled out by Controller)**

C. Contingency Acct. Beginning Bal.: \$ 300,000

D. Contingency Acct. Current Bal.: \$ 200,000

E. Current Balance After Adj.: \$ 100,000

F. Prepared/Requested By: Chuck Churchill/Gary Bork

G. Recommend Approval: Finance

H. County Board Decision: Approval/Disapproval



# REQUEST FOR BOARD ACTION

**AGENDA ITEM :** Reinstate the Clinical Director Position from .8 FTE to 1.0 FTE

Originating Division: Community Social Services

Meeting Date: 09/23/2008

Amount of Time Requested: NA

Attachments for packet:  Yes  No

Item Type:  Consent  Regular Session  Closed Session  Work Session  Ditch/Rail Authority

**BACKGROUND/EXPLANATION OF AGENDA ITEM:** The Clinical Director of the Outpatient Services Unit of the First Street Center was granted a decrease in hours from 40 to 32 hours per week (1.0 FTE to .8 FTE) by Board Action on November 23, 1999. At this time he is able to move back to a full time position. The Division is recommending that the Clinical Director position be returned to a 1.0 FTE.

**ACTION REQUESTED:** Motion to reinstate the Clinical Director position from .8 FTE to 1.0 FTE effective immediately.

**FUNDING**

County Dollars = \$

Other Sources & Amounts = \$

= \$

**TOTAL** = \$

**FISCAL IMPACT**

None

Included in current budget

Budget amendment requested

Other:

**Related Financial Comments:** Over the last year the person in this position has been working up to 80 hours a pay period. The Division has only been budgeted for 64 hours in a pay period. The FTE change will need to be added to the budgeted FTE compliment of positions. At the current time one of our Psychologists has been granted a reduction in her hours from 40 to 32. The Division has a budgeted, yet unused .2 FTE Psychologist vacancy. Given the current budget situation the Division is requesting that the additional funds for the Clinical Director be derived from the vacant .2 FTE Psychologist. At the time the Psychologist requests to return to 1.0 FTE status or there is a vacancy the Division will request funding for the vacant .2 FTE Psychologist. This will not add any budgeted funds to the current or 2009 Budget that will go unspent.

Reviewed by Division Director

Date: 09/12/2008



# REQUEST FOR BOARD ACTION

## AGENDA ITEM: Authorization to purchase "Total Station" for use by Sheriff's Crime Lab

Originating Division: Sheriff

Meeting Date: September 23, 2008

Amount of Time Requested:

Attachments for packet:  Yes  No

Item Type:  Consent  Regular Session  Closed Session  Work Session  Ditch/Rail Authority

**BACKGROUND/EXPLANATION OF AGENDA ITEM:** This request is for the Board to approve the expenditure of forfeited funds to purchase a Total Station for use by the Sheriff's Crime Lab. A Total Station is used in field operations to accurately measure and map outdoor crime scenes and traffic accidents. The Crime Lab currently possesses a Total Station that is about 15 years old that has failed. It is no longer supported by the manufacturer.

The first quote is from Northwest Lasers & Instruments for a Sokkia Set 530R3 Manual Total Station and includes batteries and charger. The price is \$7,995.00. It does not include a data collector which would have to be purchased separately for approximately \$2,500.00 (tax not included).

The second quote is from Collision Forensics Solutions for a Leica TCR-407 Power Reflectorless Basic Total Station. This complete system includes a data collector. The price for this package is \$9,820.00 (tax not included).

Both units would meet the needs of the Crime Laboratory. Since the quote from Collision Forensics Solutions is an all inclusive package and is less expensive than the cost of the Northwest Laser & Instruments, the Crime Laboratory recommends the purchase from Collision Forensic Solutions.

Total cost including tax: \$ 10,458.30

**ACTION REQUESTED:** Approval to purchase a Lecia TCR-407 Reflectorless Total Station Package as specified per quote.

### FUNDING

County Dollars =	\$
Other Sources & Amounts =	Forfeited Funds
	= \$10,458.30
<b>TOTAL</b>	<b>= \$10,458.30</b>

### FISCAL IMPACT

- None
- Included in current budget
- Budget amendment requested
- Other:

**Related Financial Comments:** These are forfeited funds which have already been collected. Per state statute these forfeited funds are for use by the Sheriff's Office only for law enforcement purposes. They are not tax dollars.

Reviewed by Division Director

Date:



# REQUEST FOR BOARD ACTION

## AGENDA ITEM : Jail Security Upgrade

Originating Division: Sheriff's Office

Meeting Date: 9/23/09

Amount of Time Requested: 10 minutes

Attachments for packet:  Yes  No

Item Type:  Consent  Regular Session  Closed Session  Work Session  Ditch/Rail Authority

### BACKGROUND/EXPLANATION OF AGENDA ITEM

We have consulted with Wold Architects and Engineers and recommend the following proposal for consideration by the Carver County Board of Commissioners:

Upgrade of our existing electronic security system by the original installation vendor, Stanley Security Systems (formerly Indiana Automation, Inc.). The upgrade includes a non-phased installation of equipment including communication intercoms, touch screen technology, security software and additional duress alarms for the Courts Addition Project. By *upgrading* the system rather than *replacing* it, it was not necessary to seek bids and the cost is substantially lower than if bids were let.  
**\$210,006.00**

Modification to the millwork in Master Control and all control panels at deputy workstations in the facility.  
**\$13,202.00**

Adjustable-height workstations to accommodate various employee sizes and provide proper ergonomics in the 24/7 operation.  
**\$3953.00**

The funds have been identified and budgeted since 2007 after a failure of the system in 2006. We bandaged the system at the time, but need the identified upgrade to the aged system and obsolete software.

**ACTION REQUESTED:** Motion for approval of County Board to complete jail security upgrade.

### FUNDING

County Dollars = \$227,261.00

Other Sources & Amounts =  
= \$

**TOTAL** = \$227,261.00

*Related Financial Comments:* Part of 2008 budget.

### FISCAL IMPACT

None

*Included in current budget*  
*Budget amendment requested*

*Other:*

Reviewed by Division Director

Reed Ashpole

Date: 9/10/2008



# REQUEST FOR BOARD ACTION

**AGENDA ITEM:** Renewal Application for On-Sale and Sunday Liquor License for Waconia Lakeside Inc dba Waconia Lakeside Ballroom

Originating Division: Property Records Taxpayer Services Meeting Date: 09-23-08  
Amount of Time Requested: 0 minutes Attachments for packet: Yes XNo  
Item Type:  Consent  Regular Session  Closed Session  Work Session  Ditch/Rail Authority

**BACKGROUND/EXPLANATION OF AGENDA ITEM:** Ricky Wagener, partner/president of Waconia Lakeside Ballroom has applied for renewal of their On-Sale and Sunday Liquor License. Waconia Lakeside is located at 8155 Paradise Lane Waconia MN 55387. There are no delinquent real estate taxes on this property.

**ACTION REQUESTED:**

Approval of the Request for Renewal of On-Sale and Sunday Liquor License for Waconia Lakeside Ballroom

**FUNDING**

County Dollars = \$  
Other Sources & Amounts = \$  
= \$  
**TOTAL** = \$

**FISCAL IMPACT**

- None
- Included in current budget
- Budget amendment requested
- Other: Not Budgeted

*Related Financial Comments:*

License Fees: On-Sale Liquor License \$1,750.00 and Sunday Liquor License \$200.00

Reviewed by Laurie Engelen Taxpayer Services Manager

Date:

9-9-08



# REQUEST FOR BOARD ACTION

**AGENDA ITEM :** Renewal Application for On-Sale and Sunday Liquor License for Timber Creek Golf Course LLC dba Timber Creek Golf Course

Originating Division: Property Records Taxpayer Services Meeting Date: 09-23-08  
Amount of Time Requested: 0 minutes Attachments for packet: Yes X No  
Item Type:  Consent  Regular Session  Closed Session  Work Session  Ditch/Rail Authority

**BACKGROUND/EXPLANATION OF AGENDA ITEM:** Shannon Burks, as General Manager of Timber Creek Golf Course has applied for renewal of their On-Sale and Sunday Liquor License. Timber Creek Golf Course is located at 9750 County Road 24, Watertown, MN 55388. There are no delinquent real estate taxes on this property.

**ACTION REQUESTED:**

Approval of the Request for Renewal of On-Sale and Sunday Liquor License for Timber Creek Golf Course

**FUNDING**

County Dollars = \$  
Other Sources & Amounts = \$  
= \$  
**TOTAL** = \$

**FISCAL IMPACT**

None  
 Included in current budget  
 Budget amendment requested  
 Other: Not Budgeted

*Related Financial Comments:*

License Fees: On-Sale Liquor \$1,500.00 Sunday Liquor \$200.00

Reviewed by Laurie Engelen Taxpayer Services Manager

Date:

9/5/08



# REQUEST FOR BOARD ACTION

**AGENDA ITEM:** Approval of out-of-state travel to SPSS training in New York, NY, October 14-15<sup>th</sup>, 2008.

Originating Division: Public Health

Meeting Date: 9/23/08

Amount of Time Requested:

Attachments for packet:  Yes  No

Item Type:  Consent  Regular Session  Closed Session  Work Session  Ditch/Rail Authority

**BACKGROUND/EXPLANATION OF AGENDA ITEM:** Staff will be sent to NY, NY in October to train on SPSS for use of County data in the Data Resource Center. The focus of this two-day course is an introduction to the statistical component of SPSS. This is an application-oriented course and the approach is practical. The class looks at several statistical techniques and discusses situations in which to use each technique, the assumptions made by each method, how to set up the analysis using SPSS as well as how to interpret the results. This includes a broad range of techniques for exploring and summarizing data, as well as investigating and testing underlying relationships. This is directly useful to current Public Health work. This training is only available out-of-state. No local training options exist.

**ACTION REQUESTED:** Approval for Tracy Bade to attend SPSS training in New York, NY, October 14-15th, 2008.

**FUNDING**

County Dollars =	\$
Other Sources & Amounts =	\$1,980
Local Public Health Grant funds	
<b>TOTAL</b>	<b>= \$ 1,980</b>

**FISCAL IMPACT**

None  
 Included in current budget  
 Budget amendment requested  
 Other:

*Related Financial Comments:*

Reviewed by Division Director

Date: Sept 10, 2008



# REQUEST FOR BOARD ACTION

**AGENDA ITEM:** Fire Alarm annual testing Fire Sprinkler annual Testing, Fire Alarm Monitoring and Fire Extinguisher annual testing.

Originating Division: Administrative Services

Meeting Date: September 23, 2008

Amount of Time Requested: 0

Attachments for packet:  Yes  No

Item Type:  Consent  Regular Session  Closed Session  Work Session  Ditch/Rail Authority

**BACKGROUND/EXPLANATION OF AGENDA ITEM:**

The National Fire Protection Agency (NFPA) requires annual testing and monitoring of all fire safety related equipment. Facilities department has coordinated testing, monitoring and inspections of this equipment under one annual contract with exception of the Justice Center/ LEC Fire alarm system. The Justice/ LEC Fire alarm system is proprietary and under a separate service contract. In addition to the fire alarm, sprinkler testing and system monitoring all required annual fire extinguishers testing and inspections will be covered under this contract.

**ACTION REQUESTED:**

Motion to approve three year contract with Simplex Grinnell LP with an annual cost not to exceed \$12,184. 00 per year. Total cost of contract for three years is \$36,552.00.

**FUNDING**

County Dollars =	\$36,552.00
Other Sources & Amounts =	= \$
<b>TOTAL</b>	= \$36,552.00

**FISCAL IMPACT**

None  
 Included in current budget  
 Budget amendment requested  
 Other:

*Related Financial Comments:* To be paid from Facilities Services Professional and Technical Fees for Service account 01-110-000-0000-6260. Annual payments for service are \$ 12,184.00 with total cost of \$ 36,552.00 for three years of services.

Reviewed by Division Director

Date:





# REQUEST FOR BOARD ACTION

## AGENDA ITEM : Agreement for Roofing Work at Lake Minnewashta Regional Park

Originating Division: Public Works/Parks

Meeting Date: September 23, 2008

Amount of Time Requested: None

Attachments for packet:  Yes  No

Item Type:  Consent  Regular Session  Closed Session  Work Session  Ditch/Rail Authority

**BACKGROUND/EXPLANATION OF AGENDA ITEM:** The 2008 Budget provides funding for a new roof for the Lake Minnewashta Beach Restroom/Change house building. The roof is past its 20 year life expectancy and has signs of deterioration. In addition, storm damage occurred to the Caretakers House, Picnic Shelter #5 and Maintenance Shop. These facilities will also receive new roofs. Funding for the storm damaged roofs is covered by the County's insurance. Two price proposals were received for the work.

Allied Construction \$37,580

Bollman Contracting \$47,280

**ACTION REQUESTED:** It is requested that the Board Chair and County Administrator sign the agreement with Allied Construction.

### FUNDING

County Dollars =	\$17,239.28
Other Sources & Amounts =	
Insurance	\$20,340.72
<b>TOTAL</b>	<b>=\$37,580.00</b>

### FISCAL IMPACT

None  
 Included in current budget  
 Budget amendment requested  
 Other:

Related Financial Comments:

Reviewed by Division Director *[Signature]*

Date: 9/10/08

S:Parks/BA RES/BA - PSA Allied Construction LMP Roofing 2008

**BOARD OF COUNTY COMMISSIONERS  
CARVER COUNTY, MINNESOTA**

Date: September 23, 2008  
Motion by Commissioner: \_\_\_\_\_

Resolution No: \_\_\_\_\_  
Seconded by Commissioner: \_\_\_\_\_

---

**PROFESSIONAL SERVICE AGREEMENT  
BETWEEN  
ALLIED CONSTRUCTION AND CARVER COUNTY  
FOR ROOFING WORK AT LAKE MINNEWASHTA REGIONAL PARK**

**BE IT RESOLVED**, that the Carver County Board of Commissioners hereby authorize the Board Chair and County Administrator to execute the Professional Service Agreement between Allied Construction and Carver County for roofing work at Lake Minnewashta Regional Park.

YES

ABSENT

NO

\_\_\_\_\_  
\_\_\_\_\_  
\_\_\_\_\_  
\_\_\_\_\_

\_\_\_\_\_  
\_\_\_\_\_  
\_\_\_\_\_  
\_\_\_\_\_

\_\_\_\_\_  
\_\_\_\_\_  
\_\_\_\_\_  
\_\_\_\_\_

---

STATE OF MINNESOTA  
COUNTY OF CARVER

I, David Hemze, duly appointed and qualified County Administrator of the County of Carver, State of Minnesota, do hereby certify that I have compared the foregoing copy of this resolution with the original minutes of the proceedings of the Board of County Commissioners, Carver County, Minnesota, at its session held on the 23rd day of September, 2008, now on file in the Administration office, and have found the same to be a true and correct copy thereof.

Dated this 23rd day of September, 2008.

\_\_\_\_\_  
County Administrator

s\parks\BA RES\ Allied Construction LMP Roofing



# REQUEST FOR BOARD ACTION

## AGENDA ITEM : SPEED ZONE STUDY REQUESTS

Originating Division: Public Works

Meeting Date: September 23, 2008

Amount of Time Requested: none

Attachments for packet:  Yes  No

Item Type:  Consent  Regular Session  Closed Session  Work Session  Ditch/Rail Authority

**BACKGROUND/EXPLANATION OF AGENDA ITEM:** The Minnesota Commissioner of Transportation is responsible for the establishment of speed limits on county roads throughout the state. Speed zoning studies by the Minnesota Department of Transportation are initiated by counties. Study requests are usually submitted to the Commissioner for newly constructed county roads, for road segments along which expanded development and more intense land use are occurring, and for road segments where there is concern about the existing speed limit. The list of County road segments contained in this agenda item reflects these reasons.

**ACTION REQUESTED:** Move to adopt resolution requesting the State of Minnesota Commissioner of Transportation to conduct speed zoning studies on county roads as listed.

### FUNDING

County Dollars = \$

Other Sources & Amounts =  
=\$

**TOTAL** =\$

*Related Financial Comments:*

### FISCAL IMPACT

None

Included in current budget

Budget amendment requested

Other:

Reviewed by Division Director

Date:

S:\Traffic Data\Speed Zone Study\2008 Speed Zone Study Requests - BAF.doc

**BOARD OF COUNTY COMMISSIONERS  
CARVER COUNTY, MINNESOTA**

Date: September 23, 2008  
Motion by Commissioner: \_\_\_\_\_

Resolution No: \_\_\_\_\_  
Seconded by Commissioner: \_\_\_\_\_

---

**SPEED ZONE STUDY REQUEST**

BE IT RESOLVED, that the Carver County Board of Commissioners hereby requests the State of Minnesota Commissioner of Transportation to conduct speed zoning studies on the following County State Aid Highway (CSAH) segments to determine the appropriate speed limits.

CSAH 10 - Between the intersection of CSAH 11 and Victoria Drive in the City of Chaska.

CSAH 11 - Between Red Oak Road and County Road 140 in the cities of Carver and Chaska.

CSAH 17 - Between CSAH 14 (Pioneer Trail) and CSAH 18 (Lyman Blvd.) in the City of Chanhassen.

YES

ABSENT

NO

\_\_\_\_\_  
\_\_\_\_\_  
\_\_\_\_\_  
\_\_\_\_\_

\_\_\_\_\_  
\_\_\_\_\_  
\_\_\_\_\_  
\_\_\_\_\_

\_\_\_\_\_  
\_\_\_\_\_  
\_\_\_\_\_  
\_\_\_\_\_

---

STATE OF MINNESOTA  
COUNTY OF CARVER

I, David Hemze, duly appointed and qualified County Administrator of the County of Carver, State of Minnesota, do hereby certify that I have compared the foregoing copy of this resolution with the original minutes of the proceedings of the Board of County Commissioners, Carver County, Minnesota, at its session held on the 23<sup>rd</sup> day of September, 2008, now on file in the Administration office, and have found the same to be a true and correct copy thereof.

Dated this 23<sup>rd</sup> day of September, 2008.

\_\_\_\_\_  
David Hemze

County Administrator



# REQUEST FOR BOARD ACTION

**AGENDA ITEM:** Renewal Application for On-Sale, Off-Sale and Sunday Liquor License for Hollywood Sports, LLC dba Hollywood Sports Complex

Originating Division: Property Records Taxpayer Services Meeting Date: 09-23-2008  
Amount of Time Requested: 0 minutes Attachments for packet: Yes XNo  
Item Type: Consent Regular Session Closed Session Work Session Ditch/Rail Authority

**BACKGROUND/EXPLANATION OF AGENDA ITEM:**  
Joseph Swartz Jr. owner of Hollywood Sports Complex has applied for renewal of their On-Sale, Off-Sale and Sunday Liquor License. Hollywood Sports Complex is located at 15950 Co Rd 122, Watertown, MN 55388. There are no delinquent real estate taxes on this property.

**ACTION REQUESTED:**  
Approval of the Request for Renewal of Off-Sale, On-Sale and Sunday Liquor License for Hollywood Sports LLC

**FUNDING**

County Dollars = \$  
Other Sources & Amounts = \$  
= \$  
**TOTAL** = \$

**FISCAL IMPACT**

None  
Included in current budget  
Budget amendment requested  
Other: Not Budgeted

**Related Financial Comments:**

License Fees: Off-Sale Liquor License \$100.00  
On-Sale Liquor License \$1,125.00  
Sunday Liquor License \$200.00

Reviewed by Laurie Engelen, Taxpayer Services Manager

Date: 9-14-08



# REQUEST FOR BOARD ACTION

**AGENDA ITEM : Layton Schlueter – Home Extended Business**

Originating Division: Land &amp; Water Services

Meeting Date: September 23, 2008

Amount of Time Requested: None

Attachments for packet:  Yes  NoItem Type:  Consent  Regular Session  Closed Session  Work Session  Ditch/Rail Authority**BACKGROUND/EXPLANATION OF AGENDA ITEM:**

File #PZ20080029. The Planning Commission recommended approval of the Conditional Use Permit (CUP) for Mr. Schlueter. He owns a 2.36 acre property in Section 13 of Camden Township. The request is for an approximate 40' x 60' building to serve as a storage structure for his small construction business. The shed should eliminate the need for any outside storage. Currently his brother is the only employee and an increase in traffic is not expected. The business is limited to two employees other than family members and two business vehicles operating from the site. The Camden Town Board supports the request.

**ACTION REQUESTED:**

A motion to adopt the Findings of Fact and to issue Order #PZ20080029 for the issuance of the Conditional Use Permit.

**FUNDING**

County Dollars = \$-0-  
 Other Sources & Amounts = -0-  
 = \$  
**TOTAL = \$-0-**

**FISCAL IMPACT**

None  
 Included in current budget  
 Budget amendment requested  
 Other:

*Related Financial Comments:* Reviewed by Division Director

Date: 9/16/2008

**COUNTY OF CARVER**  
***PLANNING COMMISSION RESOLUTION***

**FILE #: PZ20080029**

**RESOLUTION #: 08-16**

**WHEREAS**, the following application for a Conditional Use Permit has been submitted and accepted:

**FILE #:** PZ20080029

**OWNER/APPLICANT:** Layton & Michelle Schlueter

**SITE ADDRESS:** 14710 Co Rd 32, Mayer

**PERMIT TYPE:** Home Extended Business Accessory Use

**PURSUANT TO:** County Code, Chapter 152, Section 152.079 C9

**LEGAL DESCRIPTION:** See attached Exhibit "A"

**PARCEL #:** 02-013-0520

**WHEREAS**, said application was duly considered at a public hearing held by the Carver County Planning Commission at its regular meeting of September 16, 2008; and,

**WHEREAS**, the Carver County Planning Commission finds as follows:

1. Layton & Michelle Schlueter own a 2.36 acre property located in the Southwest Quarter (SW¼) of the Southeast Quarter (SE¼) of Section 13 of Camden Township. The property is improved with house with attached garage and a detached accessory structure. The property is in the Agricultural Zoning District, and the CCWRMA (Crow River).
2. The applicants are requesting a Conditional Use Permit (CUP) to construct a 2<sup>nd</sup> detached accessory structure and operate a Home Extended Business Accessory Use pursuant to Section 152.079 C9 of the Carver County Zoning Code.
3. The applicant has been operating a small construction business, Schlueter Construction, from the property since he built the home in 1999. Based on the size of the operation, it has always been classified as a Home Occupation. Due to the need for more storage space, the applicant has decided to apply for the Home Extended Business Accessory Use. Mr. Schlueter has been utilizing the existing 30' x 50' (1,500 sq. ft.) detached accessory structure for personal & equipment storage. The new structure 40' x 60' (2,400 sq. ft.) w/a 16' x 60' (960 sq. ft.) attic space above would allow Mr. Schlueter the necessary storage space for business related equipment and supplies while keeping the existing accessory structure for personal storage needs. The business equipment utilized as part of his operation would include trailers, bobcat w/attachments, building supplies, tools and misc equipment. The general idea is to be able to keep everything inside and out of the weather elements. There will be no need for water and/or septic services to the structure.
4. The business employs two (2) people, Mr. Schlueter and his brother (who does not report to site). No employees report to the site; therefore, there will not be an increase in traffic. Mr. Schlueter will be the only person needing to access the shed; therefore, there will not be a need for parking spaces even though the site has ample area. The hours of operation are 6:00 am to 7:30 pm Monday through Saturday. Typically, there will be only two (2) trips generated in & out per day, unless the need for misc. tools or equipment are needed on a jobsite.
5. The Camden Town Board reviewed and recommended approval of the request.

**THEREFORE, BE IT RESOLVED,** THAT The Carver County Planning Commission hereby recommends the issuance of CUP #PZ20080029 for A Home Extended Business Accessory Use w/accessory structure on the land described in Exhibit "A" of the permit application. The Planning Commission further recommends that the following conditions be attached to the permit:

1. The permit is subject to administrative review. A change in ownership, operations or operator shall be cause for the permit to be reviewed by Land Management for a determination as to whether an application for an amendment or similar consideration is necessary. Proposed owners and/or operators are encouraged to contact Land Management as early on in the timeline of the proposed change as possible.
2. The operation shall be in accordance with the submitted operational & site plans. These plans shall be attached to and become part of this permit.
3. All structures used in conjunction with the Home Extended Business Accessory Use operation shall meet the requirements of the Minnesota State Building Code.
4. Outside storage of business equipment, supplies and/or vehicles is permitted; however, outside storage of vehicles and equipment must be screened from neighboring residences and Co Rd 32. No more than 2 business vehicles shall be permitted.
5. The Permittee shall be responsible for obtaining proper access permits as authorized by the responsible road authority.
6. Permittee shall submit a Certificate of Workers' Compensation Insurance and/or proper affidavit to the Land Management Department. No more than 2 employees shall be permitted.
7. Section 154.18 of the Carver County Sign Code allows for an aggregate of 36 square feet of surface area, or an aggregate of 72 square feet for two-sided signs. The permittee shall not exceed the allowed square footage of signage. If the permittee is considering the addition of signage, they will be required to submit a variance application and be granted the variance request through the Board of Adjustment.
8. At all times this property shall be occupied as a homestead by a principal of the activity.

**ADOPTED** by the Carver County Planning Commission this 16<sup>th</sup> day of September, 2008.

---

Ted Beise  
Planning Commission Chair



# Camden Township

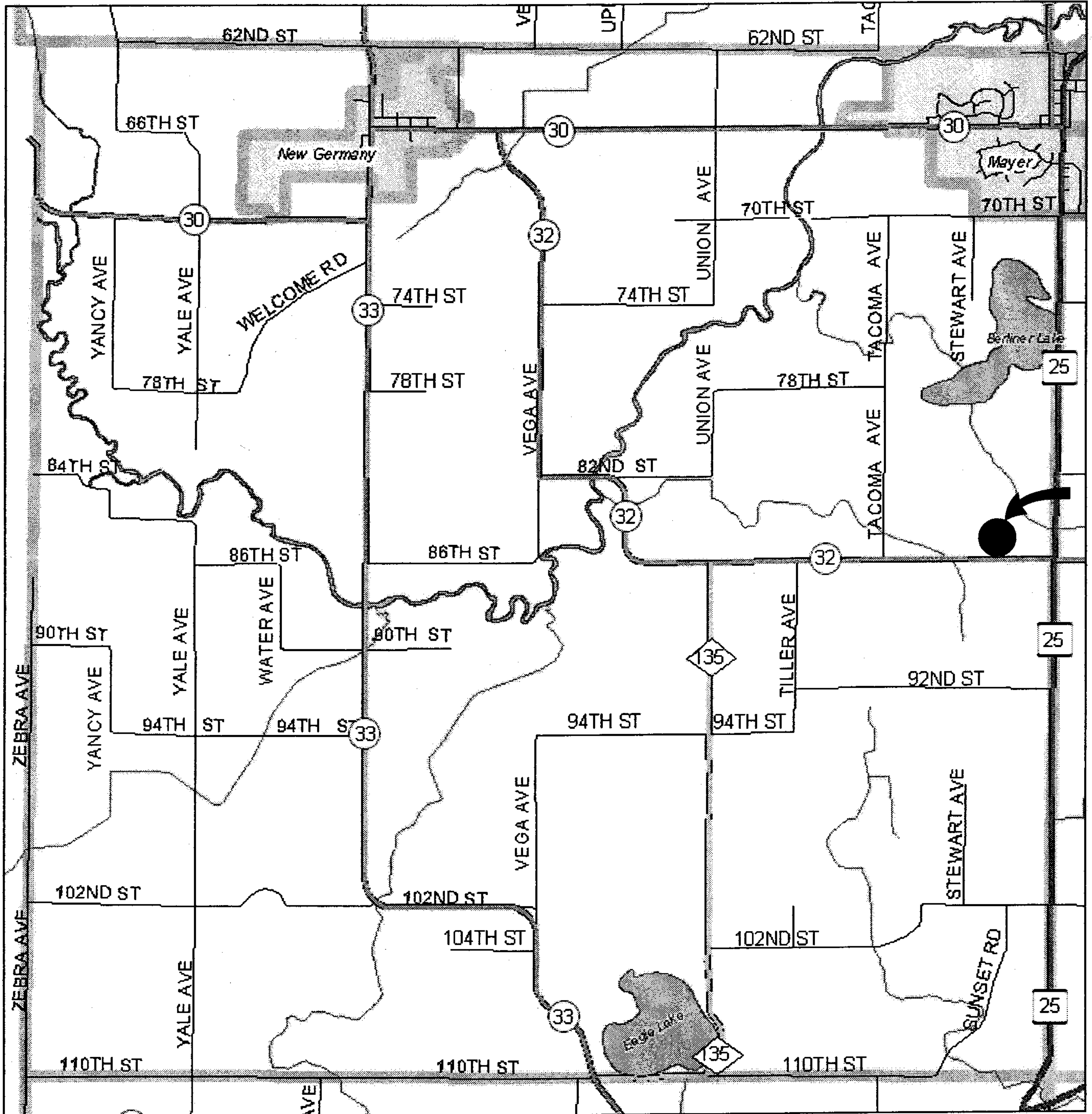

This map was created using Carver County's Geographic Information Systems (GIS), which is a compilation of information and data from various City, County, State, and Federal offices. This map is not a surveyed or legally recorded map and is intended to be used as a reference. Carver County is not responsible for any inaccuracies contained herein.



Map Created by Carver County GIS  
Apr 21, 2005

# REQUEST FOR BOARD ACTION



**AGENDA ITEM:** JPA w/MN BCA and CIS contract Amendment to develop eCharging and NEIS software adaptors

Originating Division: Sheriff's Office

Meeting Date: September 23, 2008

Amount of Time Requested: None

Attachments for packet:  Yes  No

Item Type:  Consent  Regular Session  Closed Session  Work Session  Ditch/Rail Authority

## BACKGROUND/EXPLANATION OF AGENDA ITEM:

Carver County is a Pilot Site for MN BCA's CriMNet Project. As part of this project, Carver County is working with the Sheriff's Records Management Software vendor CIS to develop two software adaptors.

One adaptor, called eCharging will facilitate moving us toward a paperless environment, reducing time & costs associated with charging criminals, reducing duplicate data entry, increasing data accuracy and consistency, enable two-way system-to-system integration and establish a standard for electronic signatures and notarizations.

The other adaptor, Name Event Index Service (NEIS) is like a Criminal Justice "Library Card Index System" which will electronically access a dozen or more systems creating accuracy and efficiency on person information and associated criminal justice event information. NEIS will create a higher level of confidence on a person's identity, their involvement in criminal events and their relationship to other criminal events. In the process it will look at such things as demographics, name and date of birth and biometrics.

Through a Joint Powers Agreement (JPA), MN BCA will provide \$147,500 in funding for Carver County to contract with the Sheriff's Record Management System vendor CIS to develop, deliver, install, test and maintain the eCharging and NEIS software adaptors. These adaptors will then be made available to all CIS customers in MN at no charge.

## ACTION REQUESTED:

**Motion to approve this JPA with MN BCA to accept funding to contract with the Sheriff's software vendor CIS for development, installation, testing and maintenance of eCharging and NEIS adaptors and;**

**Motion to approve the Amendment to the CIS Software License Agreement for development, installation, testing and maintenance of eCharging and NEIS adaptors for the Sheriff's Office Records Management software.**

## FUNDING

County Dollars = \$  
Other Sources & Amounts = \$ 147,500.00  
**TOTAL = \$ 147,500.00**

## FISCAL IMPACT

None  
 Included in current budget  
 Budget amendment requested  
 Other:

*Related Financial Comments:* Increase budget revenue line 01-201-201-0000-5320 by \$147,500.00.  
Increase budget expense line 01-201-201-0000-6265 by \$147,500.00.

Reviewed by Division Director  
Chief Deputy Bob VanDenBroeke

Date: September 11, 2008

# BUDGET AMENDMENT REQUEST FORM

**Submit to Finance Office one week prior to County Board Session.**

**DEPARTMENT: Sheriff's Office**

**Date of County Board Session: 09/23/08**

**Fund: 01**

Description of Revenue Account funds are to Increased/(Decreased):	Amount	Description of Expenditure Account funds are to Increased/(Decreased):	Amount
MNBCA Grant	\$ 147,500	Software Contract for for Echarging and NEIS projects	\$ 147,500
<b>TOTAL:</b>	<b>\$ 147,500</b>	<b>TOTAL:</b>	<b>\$ 147,500</b>

**A. Reason for Request:** See accompanying Board Action.

**B. Financial Impact: (To be filled out by Finance Director)**

**C. Contingency Acct. Beginning Bal.:** \$ 300,000

**D. Contingency Acct. Adjustment:** \$ 200,000

**E. Current Balance After Adj.:** \$ 100,000

**F. Prepared/Requested By:** Robert VandeBroeke

**G. Recommend Approval:** Finance

**H. County Board Decision:** Approval/Disapproval

S:\Excel\SHELLS\[Budget Amendment Forms.xls]Revenue Form



# REQUEST FOR BOARD ACTION

**AGENDA ITEM :** Approval porous pavement alternate bid for north Government Center parking lot

Originating Division: Administrative Services

Meeting Date: September 23, 2008

Amount of Time Requested: 5 minutes

Attachments for packet:  Yes  No

Item Type:  Consent  Regular Session  Closed Session  Work Session  Ditch/Rail Authority

**BACKGROUND/EXPLANATION OF AGENDA ITEM:** Staff is recommending approval of a \$29,600 add alternate to provide partial porous paving for the north staff parking lot by Northwest Paving and Asphalt. The base bid was originally awarded August 12, 2008 but the County recently found out alternative funding was available.

Funding is being provided through Land and Water Services Water Management - 2008 budget of \$15,000 (approved WMO watershed capital) and \$4,600 from the Low Impact Conservation Fund, and a \$10,000 grant from the Lower Minnesota River Watershed District.

Permeable paving surfaces keep the pollutants in place in the soil or other material underlying the roadway, and allow water seepage to groundwater recharge while preventing the stream erosion problems. While there are some maintenance issues associated with porous pavement, such as sanding in the winter months, we expect the life of the pavement to be similar to traditional impervious surfaces. Please see attachment for the proposed porous pavement areas at the North staff parking lot.

**ACTION REQUESTED:** Motion to approve alternate for porous paving to Northwest Paving and Asphalt for \$29,600.

**FUNDING**

Carver Co. WMO capital funds =	\$15,000
Other Sources & Amounts =	
	\$14,600
<b>TOTAL =</b>	<b>\$29,600</b>

**FISCAL IMPACT**

None  
 Included in current budget  
 Budget amendment requested  
 Other:

*Related Financial Comments:*

Reviewed by Division Director

Date: September 15, 2008

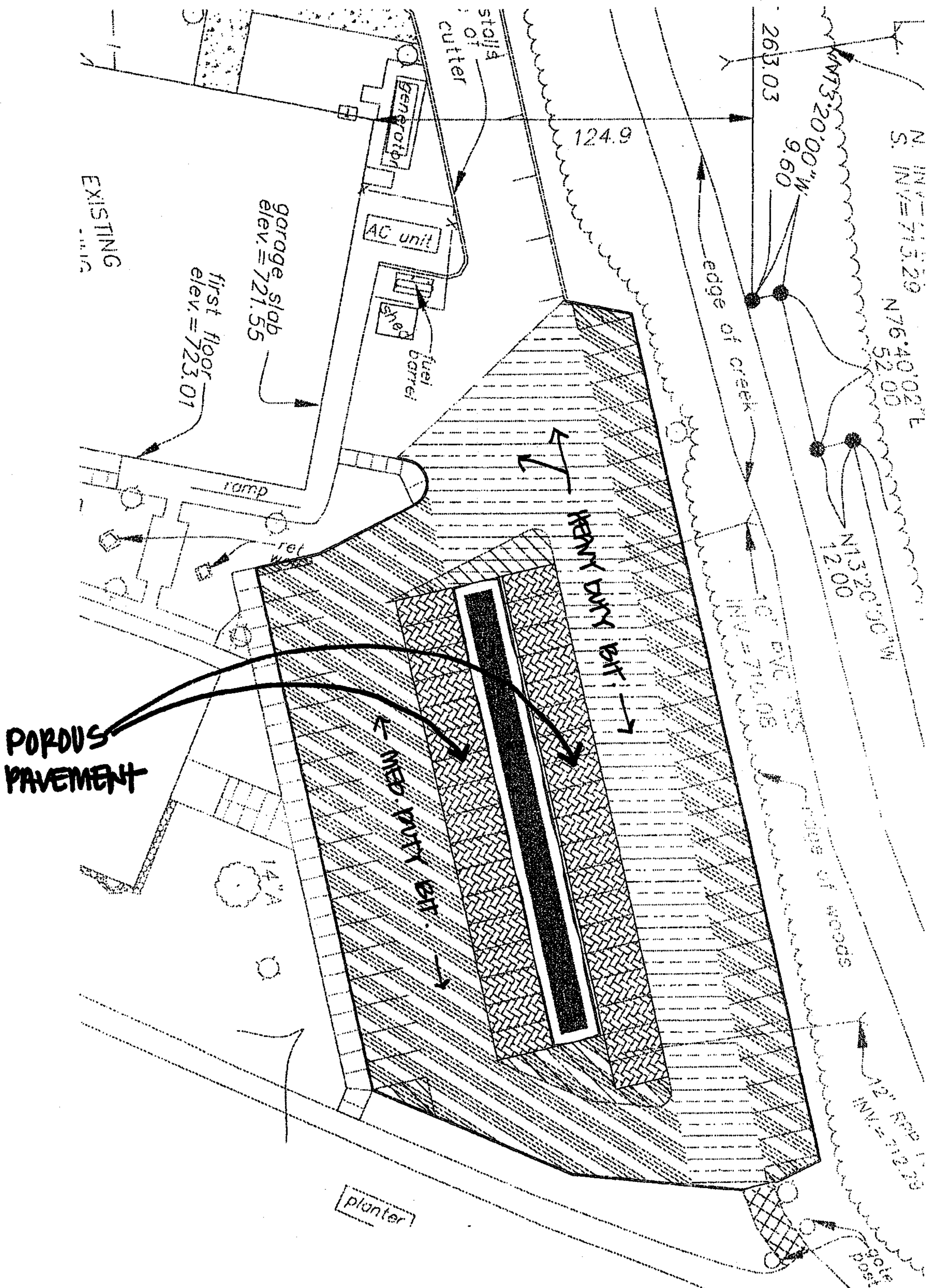

② PAVERS @ CENTER STALLS  
NO SCALE

10" A



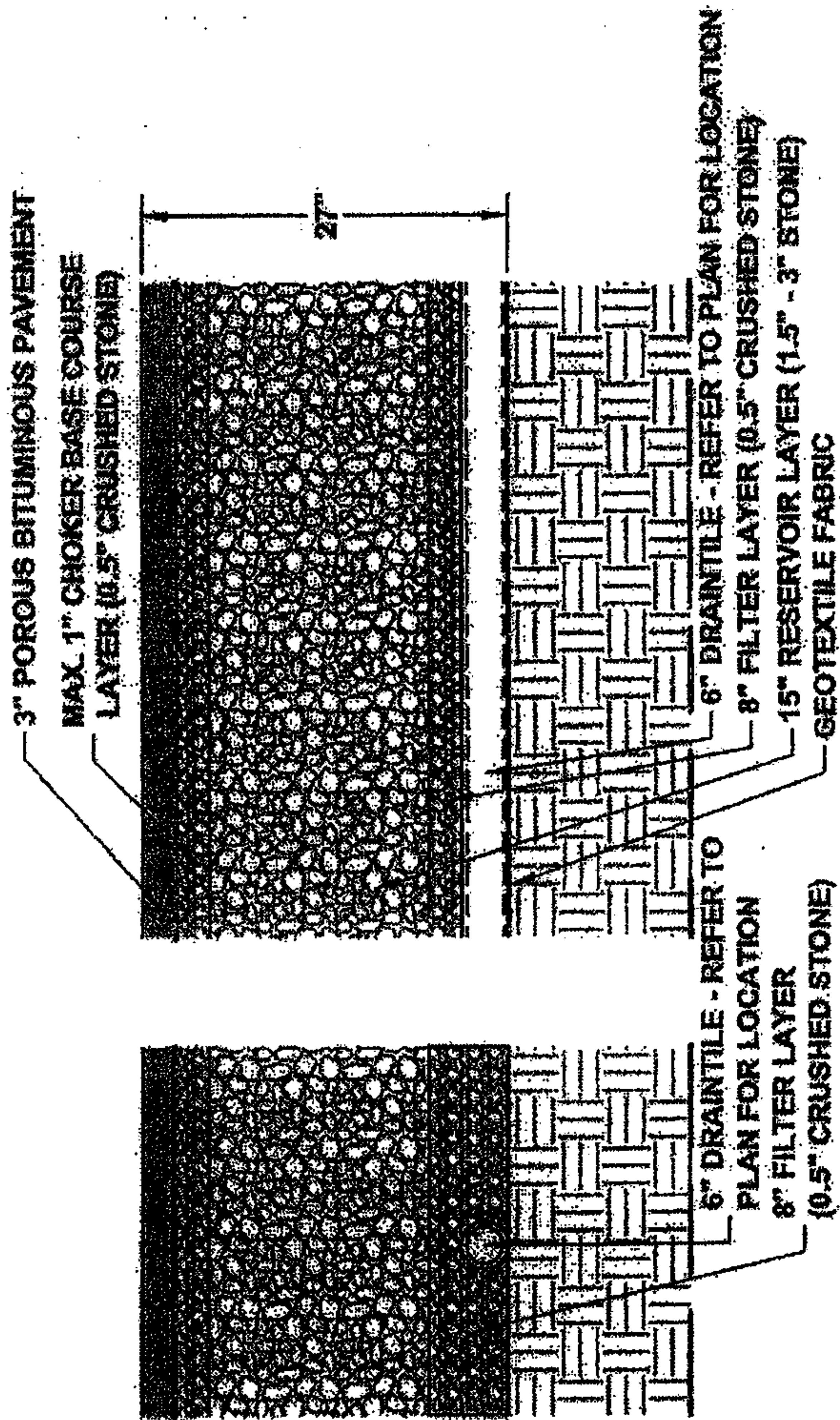

**POROUS PAVEMENT**

21  
 C7.1



# REQUEST FOR BOARD ACTION

## AGENDA ITEM : HIGH-LEVEL OVERVIEW: 2009 BUDGET & DISCRETIONARY SERVICES

Originating Division: Financial Services

Meeting Date: September 23rd

Amount of Time Requested: 1 hour

Attachments for packet:  Yes  No

Item Type:  Consent  Regular Session  Closed Session  Work Session  Ditch/Rail Authority

**BACKGROUND/EXPLANATION OF AGENDA ITEM:** The County Board approved a preliminary 2009 property tax levy that increased 8.9% compared to the 2008 property tax levy. The Board also directed staff to develop budget cuts if the Board wanted to lower the 2009 tax levy increase to 7.9% or 6.9%.

At the workshop, the Board will be provided a high level overview of the 2009 Budget with a 8.9% tax levy increase and a list of discretionary services that could be cut to lower the 2009 tax levy increase to 7.9% or 6.9%.

**ACTION REQUESTED:** Overview discussion of the 2009 preliminary budget and discretionary services funded by the Count tax levy.

### FUNDING

County Dollars = \$

Other Sources & Amounts = \$

= \$

**TOTAL** = \$

*Related Financial Comments:*

### FISCAL IMPACT

None

Included in current budget

Budget amendment requested

Other:

Reviewed by Division Director

Date: 9-15-08

**Discretionary Services  
2009 Preliminary Budget  
Carver County, Minnesota**

Service Component	Description of Service and Impact	Submitting Department	Program Cost (thousands)	Non-Tax Program Revenues (thousands)	Net Tax Levy Impact (thousands)	Revenue Generating Options
1	The County supports a variety of local programs and collaborations through grants. Grants are currently provided to the Southern Valley Alliance for Battered Women (\$15K), the Sexual Violence Center (\$15K), the CAP Agency (\$4K), and to the Agricultural Society for the County Fair (\$110K). <b>Impact:</b> These external agencies would be forced to find alternative revenue sources and/or reduce expenses.	County Board			\$144	
2	The County is a member of professional associations that provide information and services to the County Board and staff, such as AMC, NACo, MICA, and the 911 Board. The County also participates in joint powers agreements, such as the Minnesota River Basin joint powers agreement. <b>Impact:</b> Decreased information in issues affecting counties, possible loss of revenue and decreased effectiveness and efficiency of county government.	County Board			\$90	
3	Carver County is a major agricultural county ranking 10th in milk production and 4th in milk production per county square mile. A major focus is the challenges producers are facing and demands for educational information. Agriculture also includes rural urban interface, land use and environmental issues. Educating urban populations about modern agriculture and food safety. <b>Impact:</b> Less support for agricultural businesses.	Adm Serv/Extension	\$42	\$1	\$41	Increase user fees and expand use of program fees, explore partnerships
4	The Extension Service offers programs that promote healthy lifestyles, leadership, financial management and the development of gardening skills. <b>Impact:</b> Current services would be lost, including volunteer services, educational programming. Loss of grant revenues. (Note: The Master Gardener Program is a cooperative effort with Scott County.)	Adm Serv/Extension	\$68	\$2	\$66	Revenue generated through Master Gardener programs/audience ability to pay
5	The 4-H program offers youth programming through clubs, schools and site-based programs and serves 492 4-H members. Program attendance averages around 3,500 kids <b>Impact:</b> Reduced youth development opportunities.	Adm Serv/Extension	\$97	\$7	\$90	Revenue is generated by charging 4-H families a fee.
6	The Historical Society maintains a collection of artifacts and programs exhibits with monetary support from local sponsors. Library services are available for people seeking genealogical information, and educational programs are provided. <b>Impact:</b> Public access to museum and library services will be reduced, school programs will be reduced or eliminated, and artifact care and management will be greatly diminished.	Adm Serv/Historical Society	\$49	\$8	\$41	Increase fees for historical programs, expand sponsorship opportunities
7	Suspend and delay movement to electronic workflow and SharePoint Internet/Intranet conversion through 2009. <b>Impact:</b> predicted County employee work efficiency will not be realized. Examples of project work that will be cancelled include Board Action, Contracts, conversion to SharePoint intranet/internet content management. Carver County is one of five Minnesota Counties with SharePoint initiatives in Phase 1.	Adm Serv/Information Services			\$200	
8	The library's proposed 2009 levy is just under \$3.3M. Historically, the County has been required to provide a mandated maintenance of effort (MOE) for library services based on previous levy amounts. A \$70K cut would bring the levy down to the maintenance of effort limit. While this MOE has been eliminated under current law, the Governor, House and Senate leadership have agreed to remove the temporary suspension of the county maintenance of effort retroactive next session. The library does generate revenues from fees and fines and regional funding formula. <b>Impact:</b> Levels of library services would need to be reduced such as hours, books, programs, etc.	Adm Serv/Library			\$71	
9	Public information includes cable casting Board meetings, Citizen Newsletter and participation in all Community Events. \$19K has already been cut from this line item to get down to the 8.9% levy. <b>Impact:</b> Less information would be available to citizens on activities of the County Board and programs and services the County provides.	Admin Services			\$24	



	Service Component	Description of Service and Impact	Submitting Department	Program Cost (thousands)	Non-Tax Program Revenues (thousands)	Net Tax Levy Impact (thousands)	Revenue Generating Options
10	Transportation Services for Veterans	Eliminate Veteran Services transportation program. Transportation services for veterans provide them with access to medical services at the V.A. Medical Center. <b>Impact:</b> No alternative transportation services except fixed route transit services such as Southwest Metro. Veterans using the transportation services would not be able to use the V.A. Medical Center and would therefore receive care through the CSS medical assistance program.	Adm Serv/Veteran Services			\$20	
11	Custodial Services	Eliminate much of contracted custodial services efforts. <b>Impact:</b> Appearance, cleanliness, and safety of County buildings would be reduced.	Adm Serv/Facilities Management			\$20	
12	Facilities Maintenance	Further budget reduction of emergency building repairs and building improvements line items. <b>Impact:</b> Limits ability to adequately repair and restore services to affected departments. Reduces budgets to when the funds are depleted, future repairs will have to be paid for by other sources of money.	Adm Serv/Facilities Management			\$30	
13	Child Welfare and Children's Mental Health Case Management	Child welfare and children's mental health case management services are provided to children and their families. While these services are mandated, case management activities within Carver County have been more proactive compared to other counties. The Division has six case managers located in the county's four school districts that receive referrals directly from the school. An early childhood behavior specialist that assists parents and day care providers in handling challenging childhood behaviors to promote school readiness and a case manager that works with teenage mothers. <b>Impact:</b> Increase in more serious child protection cases due to lack of early intervention alternatives.	CSS	\$996	\$733	\$263	CSS and CSEC have worked extensively to refinance this due to the decrease in LCTS funding.
14	Children's Mental Health/ Treatment Services	Mental health treatment services are provided through the Visions Day Treatment Program and co-located therapists in Carver Scott Educational Cooperative programs. The therapists respond to the emotional and behavioral needs of students in the school setting and through community-based treatment services that offer professional family-based therapy services and counseling. The sex offender treatment program focuses on youth who have been adjudicated for inappropriate sexual activity. Children's Mental Health Services, including Day Treatment are mandated services. <b>Impact:</b> Eliminate collaborative efforts to address children's mental health cases, increase placement costs because of the lack of community based programs, and loss of revenues though fees, grants, and collaborations.	CSS	\$966	\$634	\$332	See Child Case Management above.
15	Adult Day Care	The Encore Adult Day Program helps older adults and adults with special needs remain in their homes longer by offering structured programming five days a week. <b>Impact:</b> Increased placement in a supportive living environment or in a nursing home.	CSS	\$289	\$322	-\$33	
16	Transportation Services for Seniors	CART, operated by CSS, available to the general public, used primarily by disabled and senior County residents, that utilize accessible buses on a deviated fix routes. <b>Impact:</b> No alternative transportation services except fixed route transit services from Southwest Metro.	CSS	\$629	\$573	\$56	CART fare increase budgeted for 2009 and collaboration with Scott County.
17	Workforce Center	The Workforce Center assists people looking for employment and connects employers with job candidates. The Workforce Center is open to the public during normal business hours and from September through May on Tuesday evenings. The Center is staffed by a Resource Specialist who assists all job seekers in accessing the resources in the Center. <b>Impact:</b> The Workforce Center would be closed to the general public and only available to enrolled Employment and Training clients. The general public would need to travel to other counties for these services.	CSS	\$69		\$69	
18	Community Outreach /Restorative Practices	Discretionary programs in the Sheriff's office include restorative practices & conferencing, POSSE, Reserves, Boat & Water, Snowmobile Patrol, Dive Team, Weights & Scales, ATV enforcement, Explorers, County CSO, County Fair coverage. <b>Impact:</b> Some, but not all of these programs have federal, state, and local funding support. Eliminating the programs would require other Office staff to assume the duties. Mn Statute 387.03 has designated responsibilities for the Sheriff's Office to do some of these duties. We would do them with other staff positions on a limited response basis. This will increase our response times. It would eliminate all volunteers from the Office that we rely on to cover community events, county fair, search and rescue work, seasonal park, trails, and water activities. It would also eliminate working with youthful offenders and sending them directly to court for minor offenses.	Sheriff			\$102	

Service Component	Description of Service and Impact	Submitting Department	Program Cost (thousands)	Non-Tax Program Revenues (thousands)	Net Tax Levy Impact (thousands)	Revenue Generating Options
19 Misdemeanor Criminal Investigations/Background Investigations/Juvenile Investigations	Investigative functions of the Sheriff's office include processing of evidence and investigation of crime scenes. The Sheriff's office also conducts background investigations of prospective law enforcement employees and prospective liquor license holders. Because of increased work loads related to juvenile crime we funded a juvenile investigator. <b>Impact:</b> Background investigations would have to be outsourced for employment and city/township liquor license when needed. Misdemeanor investigations would not be handled by the Sheriff's Office. The cities and townships would have to fund this level of service. Juvenile investigations would have to be handled by a core of county felony investigators. Misdemeanor juvenile crime would not be investigated or turned over to the local jurisdictions to investigate.	Sheriff			\$204	
20 Patrol/SERT/K-9	County-wide patrol is a discretionary service provided through MN statutes. The SERT team and K-9 programs support the patrol division. <b>Impact:</b> There would not be any routine patrol of the County and no traffic enforcement. Response times to calls (calls for assistance, crime in progress) would be slower or delayed because of the limited resources. Highly dangerous calls for service would be handled by the regular patrol staff. By eliminating the need for a K-9 program our efforts at fighting drugs, weapons violations, locating missing persons, and apprehending law violators would be greatly reduced. We will not fulfill our commitment to our contract community partners and our agreement to the City of Chaska regarding contract services.	Sheriff			\$684	
21 Juvenile Detention Center	The Sheriff currently operates a six bed 8-day temporary holdover facility adjacent to the county jail. We hold a contract with Scott County for one bed and the other beds are frequently filled with juveniles from surrounding counties. <b>Impact:</b> We would eliminate 4 FTEs. We would also lose a state grant for \$90,000. We would also have to figure in boarding costs for sending our County juveniles to another facility.	Sheriff			-\$29	
22 Sheriff - Administrative Services	Administrative services for the Sheriff's office include reductions in processing payroll and various administrative and clerical support services. This include our participation in the joint training facility in Scott County called SCALE. The elimination of our funding for tuition reimbursement. It includes reducing our clerical support for transcribing and processing reports and investigative follow ups. <b>Impact:</b> Administrative services would be scaled back resulting in delays and shifts of certain administrative functions to law enforcement officers and others in the department. Payroll would have to be done by county finance, Non-Mandated training would be eliminated causing our training cost to increase because we would have to contract for our instructors. We would eliminate our JPA for the SCALE facility in Scott County and have to find a location in Carver County to train our sworn deputies in firearms and use of force. We would scale back the tuition reimbursement program even though the CBA agreements have an article specific to reimbursement.	Sheriff			\$226	
23 Public Health Grants - Community Collaborative Support	Eliminate collaborative support to the Carver County Health Partnership (CCHP) \$65K - in addition to \$74 reduction already proposed to get down to 8.9% levy increase and \$5K contribution to River Valley Nursing Center (RVNC). <b>Impact:</b> CCHP may not be able to continue without this support. RVNC is the only low cost provider available to growing number of uninsured and underinsured residents. These external agencies would be forced to find alternative revenue sources and/or reduce expenses.	Public Health			\$70	
24 Jail Medical Services	Public health staff currently provides primary health services to Carve County jail inmates. The statutory requirement is for a medical advisor. <b>Impact:</b> Deputies would be responsible for dispensing medicine to inmates.	Public Health			\$154	
25 Public Health Programs	Public Health provides a variety of discretionary programs that could be reduced/eliminated i.e. High Risk Families (\$4K), Worksite Wellness (\$1K), Office of Aging (\$10K), at-risk population database (\$6K), Emergency Preparedness information (\$7K). <b>Impact:</b> Resources will be shifted from proactive to reactive which often can be more costly and less effective	Public Health	\$28	\$0	\$28	
26 CSAH Engineering Services	County engineering services, such as permitting, design and inspection of overlays, and traffic counting and analysis, would be reduced for the CSAH system if positions are not filled as requested. <b>Impact:</b> Potential damage to county rights-of-way, shortened life of roadways, potential loss of CSAH system apportionment, and potential increase in lawsuits.	Public Works			\$108	
27 Park Maintenance	Maintenance of county and regional park grounds and buildings is discretionary. <b>Impact:</b> Park areas would be closed for use. Regional funding for park operations, land acquisition, development and redevelopment would be eliminated. Loss of revenue for park entrance, camping, and rental equipment.	Public Works	\$412	\$41	\$371	
28 Park Programming	Curtail park programming including camping and picnic reservations, beaches staffed with lifeguards, and special events. <b>Impact:</b> Fewer events, less contact with County park personnel. Eliminating life guard services would likely have minimal impact on use of the beach.	Public Works	\$205	\$182	\$23	Increase fees for special events

Service Component	Description of Service and Impact	Submitting Department	Program Cost (thousands)	Non-Tax Program Revenues (thousands)	Net Tax Levy Impact (thousands)	Revenue Generating Options
28	Road Maintenance - General Reductions Reduced maintenance on the CSAH system, reduced pavement markings on County roads, and suspension of sign shop operation, including intra-county vehicle detailing, and building and park signage. <b>Impact:</b> Shortened life of roadways and a potential loss of CSAH apportionment and a need to outsource services for various signing products.	Public Works			\$221	Sign shop could sell services to other agencies.
29	Surveying Assistance Discretionary surveying activities include land surveying assistance to land owners and to other County departments, title survey review for minor subdivisions in unincorporated areas and assistance to the Examiner of Titles, providing survey data to support engineering design and specifications, and maintaining public land survey corners. <b>Impact:</b> Increase in problematic land issues, increase in recorded land descriptions with errors which could increase boundary disputes and litigation.	Public Works	\$175	\$2	\$173	
30	Volunteer Services - Public Works The County uses volunteers in the Adopt-A-Highway program to maintain public rights-of-way. <b>Impact:</b> Highway rights-of-way may not be free of debris and litter.	Public Works	\$96	\$16	\$80	
31	Dakota Rail Line This service preserves and improves the railroad corridor. <b>Impact:</b> Increased future cost to maintain the railroad corridor. Forfeiture of federal dollars for corridor/trail improvements.	Public Works	\$5		\$120	Increase lease agreements up to market rate.
32	Feedlot Program Water Quality The focus and intent of the program is to prevent pollution of the surface and groundwater from feedlots and manure application. This program is a critical component of the County's effort to maintain and improve water quality - the TMDL's. If this program were terminated there would be essentially no regulation of the vast majority of the feedlots in a the County and extremely limited regulation of the larger feedlots. <b>IMPACT:</b> unregulated feedlots and manure application substantially increasing pollution of the water; failure to meet agreed upon TMDL implementation goals.	LWS	\$80	\$30	\$50	Fees could be raised or operating fees could be initiated. Negative reaction in the farming community could more than offset any revenue increases
33	Soil and Water Conservation District Programs Programs provided by the SWCD include the traditional natural resource development, urban conservation & agricultural conservation technical assistance. The SWCD's role has changed significantly with advent of water quality and TMDL programs. The District performs construction site erosion control inspections under the County Water rules and a Joint Powers Agreement with the MPCA. The District plays a key role in the implementation of TMDL's through direct landowner contact and marketing of BMP's. The SWCD plays a role in the development review process and by law has a significant role in Wetland Conservation Act implementation. <b>Impact:</b> major adverse impact to water quality, stormwater, and TMDL programs.	LWS	\$734	\$423	\$311	Assessments on ditch improvements, contracts with municipalities, increased use of user fees. Move SWCD to a County facility would save about \$40,000 per year in rent & T1 line cost.
34	Court Services/ Alternative Sentencing Court Services provides several discretionary programs (not mandated, but probationers are ordered to participate by Judges of District Court). These programs include Sentence to Serve (STS), Strengthening Competencies of Youth (SCY) school-based program and cognitive-behavioral education/treatment programs. <b>Impact:</b> Without these programs, we would diminished our ability to effectively supervise and serve higher risk offenders, provide fewer sentencing alternatives for the Courts, increase costs of juvenile placement and adult incarcerations, increase probation officer workloads, and increase crime risk factors in our communities.	Court Services	\$90	\$45	\$45	

Service Component	Description of Service and Impact	Submitting Department	Program Cost (thousands)	Non-Tax Program Revenues (thousands)	Net Tax Levy Impact (thousands)	Revenue Generating Options
35	Emergency/ Risk Management Outreach Programs Statute requires coordination of activities, but discretionary services include such things as emergency planning with cities, schools, and business/industry, attendan+D18ce at special events, special trailer operations, mock car crash coordination for schools and contract reviews. <b>Impact:</b> Less emergency management coordination and training could result in less effective responses to emergency incidents. Curtailing prevention efforts in such areas as wellness and safety could result in increased claims and higher costs to the County.	Risk & Emergency Management			\$120	Cutting these services would potentially impact staffing in R&EM
36	Prosecution Contracts Carver County Attorney's Office prosecutes Gross Misdemeanors, Misdemeanors, and Petty Misdemeanors on behalf of 10 Carver County cities (exception: Chanhasen). This arrangement is critical for small communities that lack the resources to otherwise retain prosecution services from City Attorneys / private firms. Two attorneys and one support personnel are allocated to fulfill County obligation of contract. <b>Impact:</b> If the prosecution duties were given to the municipalities, overall costs would likely be higher and prosecutions would likely not be as uniform/fair as the County doing all prosecutions. The Attorney's Office would still exist to handle felony cases and other Statutorial duties.	County Attorney	\$203	\$175	\$28	Increase fee to cities for their contract share.
37	License Centers Carver County License Center serves the entire County from a License Center in Chaska and a new one being built in Chanhasen. These figures are based on license center operating revenues and expenditures from the Chaska location only in 2007. <b>Impact:</b> License Center operations positively impact tax levy.	Taxpayer Services	\$383	\$482	-\$98	
38	Absentee Ballots The County currently serves as the Absentee Precinct for the entire County. <b>Impact:</b> If this were to change and be given to the municipalities their total cost would be greater than it is with the County centralizing the process but the cost would be shifted to the municipalities. Some of the smaller municipalities would not be staffed to complete the process as directed by Statute.	Taxpayer Services	\$18	\$0	\$18	
39	Assessing Contracts The County Assessor currently assesses all property in Carver County and bills the direct costs back to the municipalities based on parcel counts. <b>Impact:</b> If the assessment duties were given to the municipalities, overall costs would likely be higher and assessments would likely not be as uniform/fair as the County doing the entire assessment. The Assessors Office would still exist to coordinate the assessment process as well as other Statutorial duties.	Taxpayer Services	\$433	\$434	-\$1	
40	Education and Training Non-mandated training includes interdepartmental coordination for staff development and other training programs. <b>Impact:</b> Employees may not have opportunities that help them learn ways to improve job effectiveness; turnover could increase; employee morale would decrease.	All Divisions			\$124	Offer training as a for-fee-service to other agencies - This seems unlikely with current+138 minimal training efforts
<b>TOTAL</b>	<b>Discretionary Services</b>				<b>\$4,656</b>	